

ENGINEERING PLANS FOR MTFPD STATION #2, JOHNSBURG PAVEMENT REHABILITATION JOHNSBURG, ILLINOIS

PLANS PREPARED FOR:

**McHENRY TOWNSHIP FIRE PROTECTION DISTRICT
CHIEF RUDY HORIST
3610 W. ELM STREET
McHENRY, ILLINOIS 60050**

**PRELIMINARY
NOT FOR CONSTRUCTION**

EXISTING	DESCRIPTION	PROPOSED
⊖	DOWN GUY	
⊙	DRAIN	
⊕	ELECTRIC TELEPHONE TV RISERS	
⊕	UTILITY HANDHOLE MANHOLE	
⊕	ELECTRIC GAS WATER METER	
⊕	UTILITY MARKER	
⊕	LIFT STATION	
⊕	SPIGOT	
⊕	TRAFFIC CONTROL BOX	
⊕	TRAFFIC CONTROL SIGNAL	
⊕	TRANSFORMER	
⊕	WELL	
⊕	SOIL BORING	
⊕	A/C UNIT	
⊕	FLAG POLE	
⊕	CURB INLET	
⊕	SANITARY MANHOLE	⊕
⊕	STORM MANHOLE	⊕
⊕	STORM CATCH BASIN	⊕
⊕	STORM INLET	⊕
⊕	FLARED END SECTION	⊕
⊕	VALVE VAULT	⊕
⊕	WATER VALVE	⊕
⊕	FIRE HYDRANT	⊕
⊕	SIGN POST	⊕
⊕	LIGHT POLE	⊕
⊕	DOWNSPOUT	⊕
⊕	BOLLARD	*BOL
⊕	UTILITY POLE	⊕
⊕	CLEANOUT	⊕
⊕	MAILBOX	⊕
⊕	WATERMAIN	⊕
⊕	SANITARY SEWER	⊕
⊕	STORM SEWER	⊕
⊕	FENCE	⊕
⊕	OVERHEAD ELECTRIC	⊕
⊕	ELECTRIC SERVICE	⊕
⊕	TELEPHONE SERVICE	⊕
⊕	GAS SERVICE	⊕
⊕	COMBINED SEWER	⊕
⊕	MAJOR CONTOUR	⊕
⊕	MINOR CONTOUR	⊕

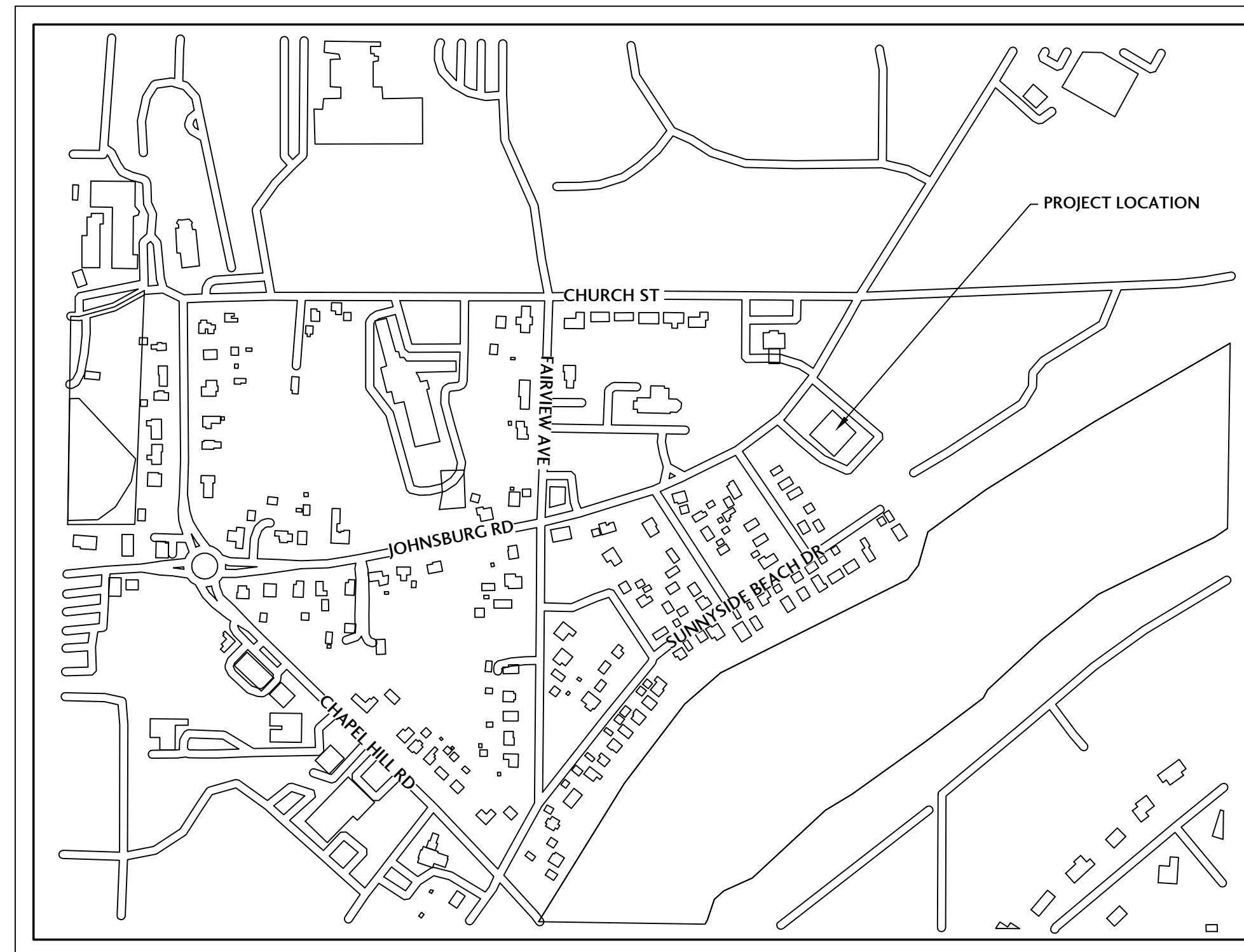

LOCATION MAP
N.T.S.

BENCHMARKS	
SITE BENCHMARK #1:	BENCH TIE IN WLY FACE OF UTILITY POLE ELEV=778.53 NAVD88
SITE BENCHMARK #2:	ARROW BOLT ON FIRE HYDRANT ELEV=751.13 NAVD88



**Know what's below.
Call before you dig.**

OPERATES
24 Hours
365 Days

CALL JULIE 1-800-892-0123
WITH THE FOLLOWING:
COUNTY McHENRY
CITY-TOWNSHIP VILLAGE OF JOHNSBURG
SEC. & 1/4 SEC. NO.# NW 1/4 SEC 18, T45N, R9E
48 Hours Before You Dig.
EXCLUDING SAT., SUN., & HOLIDAYS

SHEET INDEX:	
C0.0	COVER SHEET
C0.1	SPECIFICATIONS AND TYPICAL SECTIONS
C1.0	EXISTING CONDITIONS AND DEMOLITION PLAN
C2.0	OVERALL SITE PLAN
C2.1	ALTERNATE BID OVERALL SITE PLAN
C2.2	GEOMETRIC UTILITY PLAN
C3.0	UTILITY & GRADING PLAN
C4.0	STANDARD DETAILS
C4.1	STANDARD DETAILS



ISSUED FOR BID/PERMIT

I HEREBY CERTIFY THAT THE PLANS WITH THE FIRM'S NAME LISTED BELOW WERE PREPARED UNDER MY DIRECT SUPERVISION. FURTHERMORE, THE PROPOSED PROJECT WILL NOT RESULT IN DRAINAGE, EROSION OR RUNOFF WHICH ADVERSELY IMPACTS ADJACENT PROPERTIES OR THE PUBLIC RIGHT-OF-WAY. THE PLANS PREPARED MEET THE MINIMUM REQUIREMENTS OF THE McHENRY COUNTY STORMWATER MANAGEMENT ORDINANCE. DATED AT RINGWOOD, ILLINOIS THIS 14TH DAY OF FEBRUARY, 2024

James E. Condon

JAMES E. CONDON, P. E., J. CONDON & ASSOCIATES, INC.
ILLINOIS REG. PROF. ENGINEER No. 062-044555 EXPIRATION DATE 11-30-2025
ILLINOIS DEPARTMENT OF PROFESSIONAL REGULATION FIRM NUMBER: 184-006759

J. CONDON & ASSOCIATES, INC.
CONSULTING ENGINEERS
5415 BUSINESS PARKWAY
RINGWOOD, ILLINOIS 60072
815.728.0068
IL DESIGN FIRM # 184-006759

**McHENRY TWP.
FIRE PROTECTION
DISTRICT
McHENRY,
ILLINOIS**

N
W E
S

SCALE
N/A

ISSUE DATE
02/14/2024

PROJECT MANAGER
JEC

DESIGNER
LRT

QUALITY CONTROL
MAM

**MTFPD STATION #2,
JOHNSBURG
PAVEMENT
REHABILITATION
JOHNSBURG,
ILLINOIS**

NO.	DATE	DESCRIPTION

LIMITATION OF WARRANTY OF ENGINEER'S INSTRUMENTS OF SERVICE
THE ENGINEER AND HIS CONSULTANTS DO NOT WARRANT OR GUARANTEE THE ACCURACY AND COMPLETENESS OF THE DELIVERABLES HEREIN BEYOND A REASONABLE DILIGENCE. IF ANY MISTAKES, OMISSIONS, OR DISCREPANCIES ARE FOUND TO EXIST WITHIN THE DELIVERABLES, THE ENGINEER SHALL BE PROMPTLY NOTIFIED SO THAT HE MAY HAVE THE OPPORTUNITY TO TAKE WHAT STEPS NECESSARY TO RESOLVE THEM. FAILURE TO PROMPTLY NOTIFY THE ENGINEER OF SUCH CONDITIONS SHALL ABSOLVE THE ENGINEER FROM ANY RESPONSIBILITY FOR THE CONSEQUENCES OF SUCH FAILURE. ACTIONS TAKEN WITHOUT THE KNOWLEDGE AND CONSENT TO THE ENGINEER, OR IN CONTRADICTION TO THE ENGINEER'S DELIVERABLES FOR RECOMMENDATIONS, SHALL BECOME THE RESPONSIBILITY NOT OF THE ENGINEER BUT OF THE PARTIES RESPONSIBLE FOR TAKING SUCH ACTION.

PROJECT NUMBER
MTFP-23087-3

SHEET TITLE
COVER SHEET

SHEET NUMBER
C0.0

**PRELIMINARY
NOT FOR CONSTRUCTION**

Design Special Provisions

The Standard Specifications for Road and Bridge Construction prepared by the Department of Transportation of the State of Illinois (latest edition), Supplemental Specifications, the Standard Specifications for Water and Sewer Main Construction in Illinois (latest edition) and the Illinois Urban Manual (blue book) as published by the IEPA shall govern the construction of this project.

In addition, the following special provisions supplement the said specifications, and in case of conflict with any part or parts of said specifications, these special provisions shall take precedence and shall govern.

1. Scope of Work

The proposed improvement consists of supplying all the necessary labor, material and equipment to satisfactorily construct and install all improvements according to the plans designated "MTPD STATION #2, JOHNSBURG PAVEMENT REHABILITATION."

2. Construction Of Underground Utilities

A. Excavation: Where working conditions and right-of-way permit, pipe line trenches with sloping sides may be used.

The slopes shall not extend below the top of the pipe, and the trench excavations below this point shall be made with vertical sides with widths not exceeding those specified herein for the various sizes of pipe.

Open-cut trenches shall be sheeted and braced as required by the governing state, federal laws and municipal ordinances, and as may be necessary to protect life, property or the work.

Where firm foundation is not encountered at the grade established, due to unsuitable soil, all such unsuitable material shall be removed and replaced with approved compacted granular material.

B. Width of Trenches: The maximum width of the trench at the top of the pipe shall be as follows:

Table with 2 columns: Nominal Pipe Sizes (inches) and Trench Widths (inches). Rows include sizes 12 or smaller, 14-18, 20-24, 27-30, and 33 and larger.

C. Removal of Water: Contractors shall, at all times during construction, provide and maintain ample means and devices with which to remove and properly dispose of all water entering the excavations. No sanitary sewer shall be used for disposal of trench water, unless specifically approved by the City Engineer and then only if the trench water does not ultimately arrive at existing pumping or sewage treatment facilities.

D. Bedding of Pipe: All pipe shall be installed on a bedding of approved, compacted granular material unless otherwise approved by the City Engineer. The bedding material shall be installed as per the typical trench backfill detail.

E. Trench Backfill: Whenever the excavation is in or within 2 feet of existing or proposed streets, parking areas, driveways, sidewalks or other paved areas, the trench shall be backfilled with approved selected granular material compacted in place. The granular material shall consist of CA-6 and extend away from the back of curb or any edge of pavement at a 1 to 1 slope. The top 12 inches of the backfill shall be filled with road gravel or crushed stone and maintained as a temporary surface for the normal use of the area when the trench is in existing pavements.

F. Restoration of Drainage: As soon as possible after backfilling the trench, all ditching, grading and shaping necessary to restore the original drainage in the area of work shall be performed. Culverts removed during the course of the work shall be replaced as soon as practical after backfilling is complete.

G. Utilities: The contractor shall notify all utilities prior to the installation of any pipelines. Where conflicts exist between underground utilities and the proposed underground pipeline requiring a revision to the plans, such construction shall not be undertaken until such changes are approved by the City Engineer in writing.

3. Inspection

All improvements shall be subject to inspection by a duly authorized and qualified Owner's Representative both during the course of construction and after construction is complete. The Owner's Representative shall have authority over materials of construction, methods of construction and workmanship to ensure compliance with working drawings and specifications. The contractor shall provide for reasonable tests and proof of quality of materials as requested by the inspector. Upon due cause, which shall include weather conditions, workmanship or non-adherence to the approved plans and specifications, the inspector shall have the authority to stop construction.

4. Storm Sewers

Storm sewers shall be of reinforced concrete pipe meeting the requirements of ASTM C-76. Pipe shall be Class III for depths less than or equal to 14 feet and Class IV for depths exceeding 14 feet or less than 3 feet under paved surfaces. All joints shall be completed with mast joint materials.

OR

Corrugated Polyethylene (HDPE) Pipe with Smooth Interior. Pipes and fittings shall meet the requirements of AASHTO M-294 (12" and larger), Type 5 (corrugated outside smooth inside, 4" -48"). The joints shall be bell

and spigot having a factory installed Elastomeric rubber "O-ring" gasket which meets ASTM F-477.

OR

Corrugated Polypropylene (CPP) Pipe with Smooth Interior. Pipes and fittings shall meet the requirements of AASHTO M-330 (12" and larger). The joints shall be bell and spigot having meeting the requirements of ASTM F2881 or AASHTO M330 with a factory installed Elastomeric rubber "O-ring" gasket which meets ASTM F-477.

OR

PVC storm sewer shall be SDR 26 ASTM D3034 with ASTM D3212 joints.

5. Storm Sewer Frames And Grates

All frames falling in paved area shall be EJIW 1050 or approved equal. All frames and grates in grassed areas shall be NEENAH R-4342 or approved equal.

6. Earth Excavation

This item shall include stripping and stockpiling of all topsoil in areas designated by the Owner's Representative. All material deposited in embankment areas shall be compacted under the direction of the Owner's Representative. Topsoil shall be stripped in all fill areas before placement of material. All excess material shall be disposed of off-site at an approved facility by the contractor unless otherwise directed by the Owner.

7. Topsoil Placement

The contractor shall place topsoil to a minimum depth of 6 inches over all unpaved disturbed areas ready for landscaping. The surface of the topsoil shall be free from clods, stones, sticks and debris. Placement shall include spreading, cultivating, lightly compacting, dragging and grading. Topsoil, when placed, shall be dry enough so as not to puddle or bond. Topsoil shall not be placed when the subgrade is frozen, excessively wet, or in any other condition detrimental to proper grading. Remove all foreign matter and soil clods larger than 1" in diameter. If undesirable vegetation is present prior to seeding, the topsoil shall be disked until all vegetation has been removed

8. Seeding

All disturbed unpaved areas shall be seeded with Kentucky Bluegrass mixture or with another mixture approved by the owner's representative. All seeded areas shall be covered with the specified erosion control matting. All seeded areas shall have an adequate growth of grass before work is accepted. All seeded areas shall be stabilized within 24 hours after seeding operations have been completed. The owner's representative shall approve the seed bed prior to sowing any seeds. Prior to starting seed work, contractor shall submit the name of seed supplier for the project and labels from the bags. The seed shall be sown with a machine that mechanically places the seed in direct contact with the soil, packs, and covers the seed in one continuous operation. Broadcasting will be allowed as approved by owner's representative in inaccessible areas where the use of the equipment specified is physically impossible. Adequate growth will be defined as root depth into topsoil a minimum of 2" and dense, green, consistent turf void of any bare or patchy areas of more than 9 square inches. The contractor shall maintain the turf grass until final acceptance. Maintenance to include grade repair, reseeding, mowing, insect & weed control, trimming & edging. Each mowing shall occur when the grass has reached a height of 4 inches. Mow to a height of 3 inches, turf shall be mowed so as not to remove more than 1/3 of the total height. The cost of such maintenance shall be included in the turf grass installation cost. All seeded areas shall have an adequate growth of grass before work is accepted.

9. Traffic Control

The contractor shall obtain, erect, maintain and remove all signs, barricades, flagman, and other traffic control devices as may be necessary for the purpose of regulating, warning or guiding traffic or pedestrians. Placement and maintenance of all traffic control devices shall be as directed by the municipal inspector and in accordance with the applicable parts of Article 701 of the Standard Specifications for Road and Bridge Construction. All traffic protection will be considered incidental to the contract.

10. Engineer's Responsibility

The engineer shall be responsible for the following:

- A. To visit the construction site in order to better carry out the duties and responsibilities assigned by the Owner and undertaken by the engineer;
B. The engineer shall not, during such visits or as a result of such observations of the contractor's work in progress, supervise, direct, have control over the contractor's work, nor shall the engineer have the authority over the responsibility for the means, methods, techniques, sequences, or procedures of construction selected by the contractor for safety precautions and programs incidental to the work of the contractor, or for any failure of the contractor to comply with the laws, rules, regulations, ordinances, codes or orders applicable to the contractor furnishing and performing his work. Accordingly, the engineer can neither guarantee the performance of the construction contracts by the contractor nor assume responsibility for the contractor's failure to furnish and perform his work in accordance with the contract documents.

11. Construction Drawings/Contractor's Responsibility

No construction plans shall be used for construction unless specifically marked "For Construction." Prior to commencement of construction, the contractor shall verify all dimensions and conditions affecting their work with the actual conditions at the job site. In addition, the contractor must verify the engineer's line and grade stakes. If there are any discrepancies from what is shown on the construction plans, he must immediately report same to the engineer before doing any work, otherwise, the contractor assumes full responsibility. In the event of disagreement between the construction plans, Standard Specifications and/or special details, the contractor shall secure written instructions from the engineer prior to proceeding with any part of the work effected by omissions or discrepancies. Failing to secure such instructions, the contractor will be considered to have proceeded at his own risk and expense. In the event of any doubt or question arising with respect to specifications, the decision of the engineer shall be final and conclusive.

12. Indemnification

The contractor shall indemnify and hold harmless the Owner and J. Condon & Associates, Inc. from and against all claims, damages, losses and expenses, including attorney's fees arising out of or resulting from the performance of the contractor's work. In any and all claims against the owner or J. Condon & Associates, Inc., by any employee of the contractor, or anyone directly or indirectly employed by the contractor, or anyone for whose acts the contractor may be liable, the indemnification obligation shall not be limited in any way by any limitation on the amount of damages, compensation or benefits payable by or for the contractor under Worker's Compensation acts, disability benefit acts or other employee benefit acts.

13. Preconstruction Conference

A preconstruction conference for representatives of the developer, municipality and contractor will be held before the contractor proceeds with construction, at a time and place convenient for all parties, for review of the contractor's construction schedules, to establish procedures for handling shop drawing and other submittals and to establish a working understanding among the parties to the contract work.

14. Project Quantities

The quantities given by the engineer are intended as a guide for the contractor in determining the scope of the completed project. It is the contractor's responsibility to determine all material quantities and appraise himself of all site conditions. The contract price submitted by the contractor shall be considered as lump sum for the completed project. No claims for extra work will be recognized unless ordered in writing by the Owner.

15. Insurance Requirements

The contractor shall purchase and maintain Comprehensive General Liability and other insurance set forth below which will provide protection from claims which may arise out of or resulting from the performance of work by anyone directly or indirectly employed by the contractor or by anyone for whose acts the contractor may be liable.

A. Worker's Compensation and Employer's Liability insurance in any amount not less than statutory limits required by law.

B. Comprehensive General Liability insurance including coverage in the amount of \$500,000 per accident for property damage and \$1,000,000 per person and \$2,000,000 aggregate per accident for bodily injury, sickness or disease, or death of any person.

C. Comprehensive Automobile Liability insurance covering all automobiles, trucks, trailers and any other motorized equipment owned or leased by the contractor.

16. Certificate of Insurance

The contractor shall not commence work until he has filed with the Owner's Representative a certificate of insurance showing complete coverage of all insurance required, signed by the insurance companies or their authorized agents. Each certificate shall provide that coverage shall not be terminated or reduced without 30 days advance written notice to the Owner's Representative. The contractor shall name the Owner & J. Condon & Associates, Inc. as additional insureds on the Comprehensive General Liability and Automobile Liability policies.

17. Erosion Control

It shall be the contractor's responsibility to properly control erosion on the job site through the use of siltation ponds, filter fabrics, etc. Any siltation of conduits, structures, or ditches shall be cleaned and maintained by the contractor until the seeding has taken hold. All washouts, gullies, etc. will be regraded and reseeded by the contractor.

The contractor's responsibility for erosion control shall extend throughout the construction process. The contractor shall be responsible for clean-up of paved surfaces within and outside of the project.

All erosion control practices shall comply with the latest revision of the Illinois Urban Manual (Blue Book) as published by the IEPA.

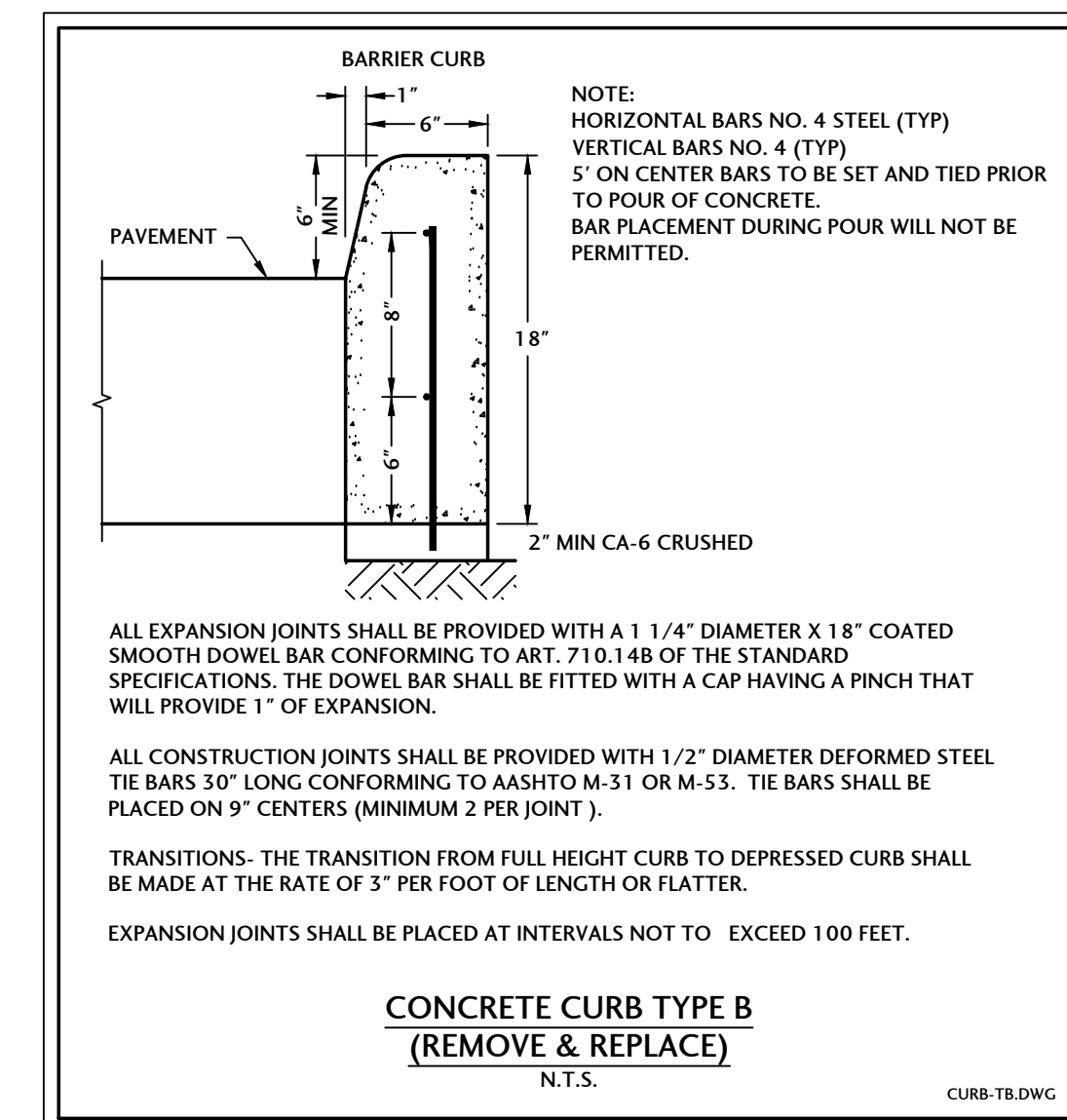
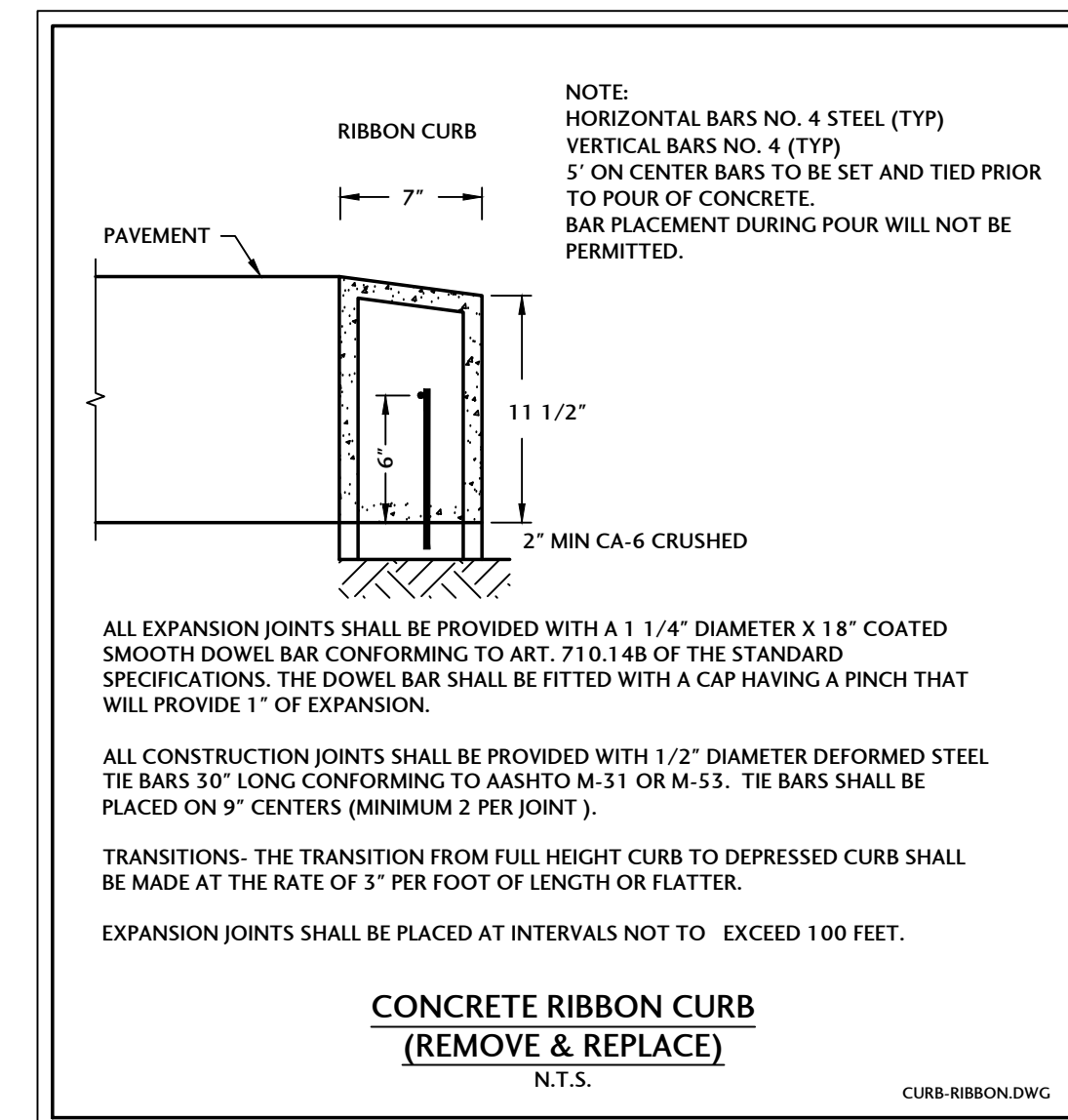
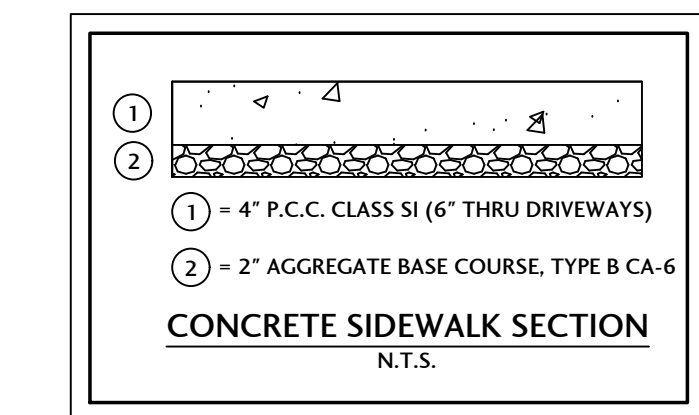
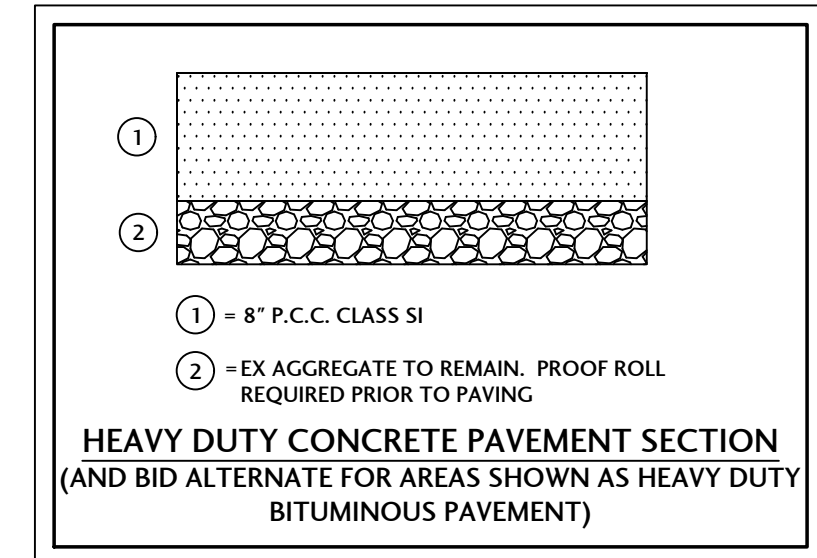

Standard Soil Erosion and Sediment Control Notes

- 1. Control measures shall meet the minimum standards and specifications of the Illinois Urban Manual (www.aiswcd.org/IUM) unless stated otherwise.
2. Soil disturbance shall be conducted in such a manner as to minimize erosion. Areas of the development site that are not to be disturbed shall be protected from construction traffic or other disturbance until final stabilization is achieved.
3. Soil stabilization measures shall consider the time of year, development site conditions and the use of temporary or permanent measures.
4. Stabilization by seeding shall include topsoil placement and fertilization, as necessary.
5. Native seed mixtures shall include rapid-growing annual grasses or small grains to provide initial, temporary soil stabilization.
6. Offsite property shall be protected from erosion and sedimentation. Velocity dissipation devices shall be placed at concentrated discharge locations and along the length of any outfall channel, as necessary to prevent erosion.
7. Sediment control measures shall be installed prior to the disturbance of tributary areas.
8. Stabilization of disturbed areas shall be initiated immediately whenever any clearing, grading, excavating or other earth disturbing activities have permanently ceased on any portion of the development site, or temporarily ceased on any portion of the development site and will not resume for a period exceeding 14 calendar days.
9. Disturbance of steep slopes shall be minimized. Areas or embankments having slopes steeper than 3:1 shall be stabilized with staked in place soil, erosion control blanket in combination with seeding, or an equivalent control measure.
10. Perimeter control measures shall be provided downslope and perpendicular to the flow of runoff from disturbed areas, where the tributary area is greater than 5,000 square feet, and where runoff will flow in a sheet flow manner. Perimeter erosion control shall also be provided at the base of soil stockpiles.
11. The stormwater management system shall be protected from erosion and sedimentation downslope from disturbed areas. Inlet protection that reduces sediment loading, while allowing runoff to enter the inlet shall be required for all storm sewers. Check dams, or an equivalent control measure, shall be required for all channels. Filter fabric inlet protection and straw bale ditch checks are not acceptable control measures.
12. If dewatering services are used, discharges shall be routed through an effective sediment control measure (e.g., sediment trap or an equivalent control measure). The Enforcement Officer shall be notified prior to the commencement of dewatering activities.
13. All temporary soil erosion and sediment control measures shall be removed within 30 days after final stabilization of the development site is achieved or after the temporary measures are no longer necessary. Trapped sediment shall be removed and disturbed areas shall be permanently stabilized.
14. Stockpiled soil and materials shall be removed from flood hazard areas at the end of each work day. Soil and materials stockpiled in IWMC or buffer areas shall be placed on timber mats, or an equivalent control measure.
15. Effective control measures shall be utilized to minimize the discharge of pollutants from the development site. At a minimum, control measures shall be implemented in order to:
a. Minimize the discharge of pollutants from equipment and vehicle washing, wheel wash water, and other wash water; and
b. Minimize the exposure of building materials, building products, construction wastes, trash, landscape materials, fertilizers, pesticides, herbicides, detergents, vehicle fluids, sanitary waste, and other materials present on the development site to precipitation and to stormwater.
16. Adequate receptacles shall be provided for the depositing of all construction material debris generated during the development process. The applicant shall not cause or permit the dumping, depositing, dropping, throwing, discarding or leaving of construction material debris upon or into any development site, channel, or IWMC. The development site shall be maintained free of construction material debris.
17. The Enforcement Officer may require additional or alternate soil erosion and sediment control measures, based on development site specific considerations and the effectiveness of the installed control measures.
Standard Drain Tile Notes
1. Drain tiles disturbed during regulated development shall be reconnected by those responsible for their disturbance, unless the development plans specify abandonment of the drain tiles.
2. All abandoned drain tiles within disturbed areas shall be removed in their entirety.
3. Drain tiles within the disturbed area of a development site shall be replaced, bypassed around the development site or intercepted and connected to the stormwater management system for the development site. The size of the replaced or bypassed drain tile shall be equivalent to the existing drain tile.

Table with columns for Seed Mixture, Moisture Regime, Sun, Salt Tolerance, and Seeding Rates (PLS) and Seeding Dates for Spring, Fall, and Dormant periods.



J. CONDON & ASSOCIATES, INC. CONSULTING ENGINEERS 5415 BUSINESS PARKWAY RINGWOOD, ILLINOIS 60072 815-728-0068 IL DESIGN FIRM # 184-006759

McHENRY TWP. FIRE PROTECTION DISTRICT McHENRY, ILLINOIS

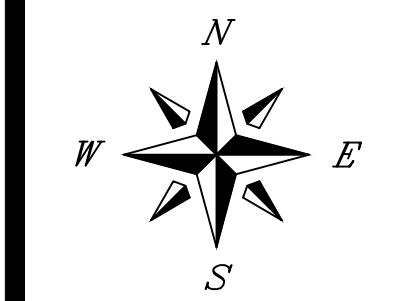

SCALE N/A ISSUE DATE 02/14/2024 PROJECT MANAGER JEC DESIGNER LRT QUALITY CONTROL MAM

MTPFD STATION #2, JOHNSBURG PAVEMENT REHABILITATION JOHNSBURG, ILLINOIS

DESCRIPTION

DATE

NO.

PROJECT NUMBER MTFP-23087-3

SHEET TITLE SPECIFICATIONS AND TYPICAL SECTIONS

SHEET NUMBER

C0.1

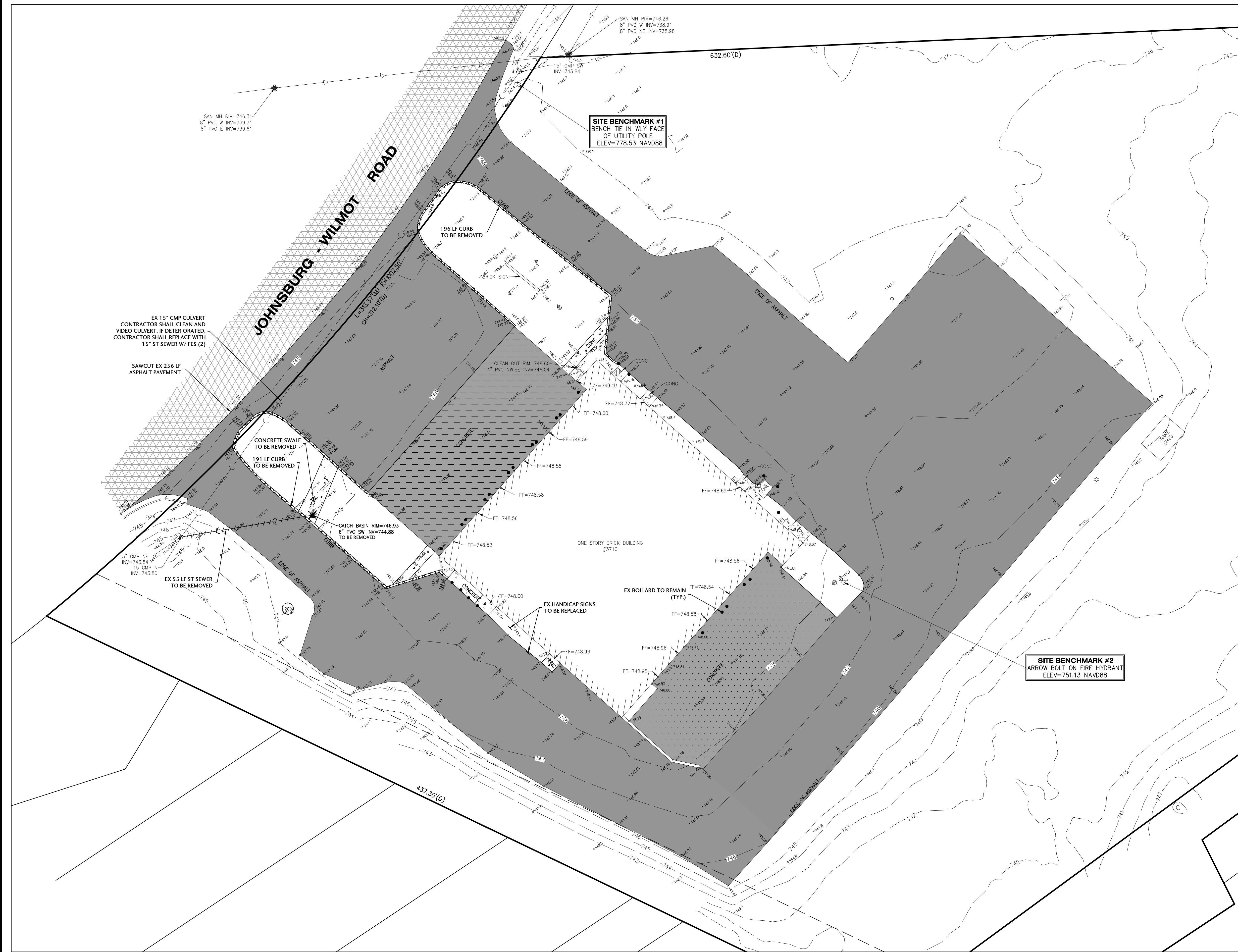

- ### DEMOLITION NOTES
- CONTRACTOR SHALL FIELD VERIFY EXISTING UTILITY LOCATIONS AND ELEVATIONS PRIOR TO DEMOLITION. SOME UTILITIES MAY NOT BE SHOWN.
 - COORDINATE WITH LOCAL AUTHORITIES AND UTILITY PURVEYORS FOR THE REMOVAL/RELOCATION OF EXISTING UTILITIES.
 - SAWCUTTING OF EXISTING PAVEMENT SHALL BE FULL DEPTH TO PROVIDE A CLEAN VERTICAL FACE TO MATCH PROPOSED PAVEMENT.
 - KEEP ALL PUBLIC AND PRIVATE STREETS CLEAR OF CONSTRUCTION DEBRIS, TRASH, AND MATERIALS. ALL ADJOINING PUBLIC AND PRIVATE PROPERTIES SHALL BE PROTECTED FROM DAMAGED CAUSED BY CONSTRUCTION.
 - ALL WASTE MATERIALS SHALL BE DISPOSED OF OFFSITE IN AN APPROVED FACILITY.
 - ALL WASTE MATERIALS SHALL BE REMOVED IN A MANNER THAT PREVENTS INJURY OR DAMAGE TO PERSONS, ADJOINING PROPERTIES AND/OR RIGHT-OF-WAY.
 - ALL EROSION CONTROL MEASURES SHALL BE INSTALLED PRIOR TO DEMOLITION OPERATIONS.
 - THE SITE SHALL BE GRADED TO MINIMIZE ACCUMULATION OF WATER OR DAMAGE TO ANY FOUNDATIONS ON THE PREMISES OF ADJOINING PROPERTY.

LEGEND

- = EXISTING BITUMINOUS PAVEMENT
- = EXISTING CONCRETE SIDEWALK
- = EXISTING BUILDING
- = PAVEMENT TO BE REMOVED (PHASE I)
- = CONCRETE PAVEMENT TO BE REMOVED (PHASE I)
- = PAVEMENT TO BE REMOVED (PHASE II)
- = CONCRETE PAVEMENT TO BE REMOVED (PHASE II)
- = CONCRETE SIDEWALK TO BE REMOVED (PHASE II)
- = FULL DEPTH SAWCUT
- = UTILITY PIPE REMOVAL
- = CURB REMOVAL
- = STRUCTURE REMOVAL

SITE DATA TABLE

PROPERTY AREA:	5.03 ACRES
IMPERVIOUS AREA:	44,804 SF 1.03 ACRES
DISTURBANCE AREA:	71,243 SF 1.64 ACRES

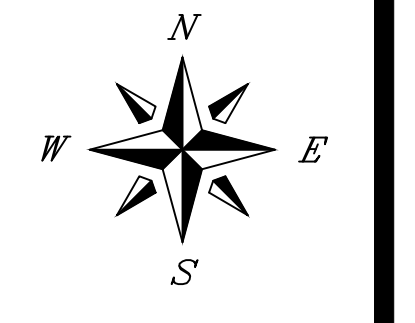
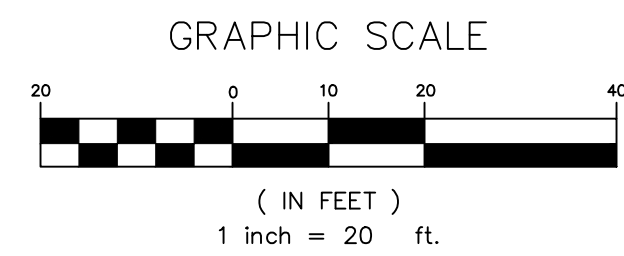

NO.	DATE	DESCRIPTION



J. CONDON & ASSOCIATES, INC.
 CONSULTING ENGINEERS
 5415 BUSINESS PARKWAY
 RINGWOOD, ILLINOIS 60072
 815.728.0068
 IL DESIGN FIRM # 184-006753

McHENRY TWP.
 FIRE PROTECTION
 DISTRICT
 McHENRY,
 ILLINOIS

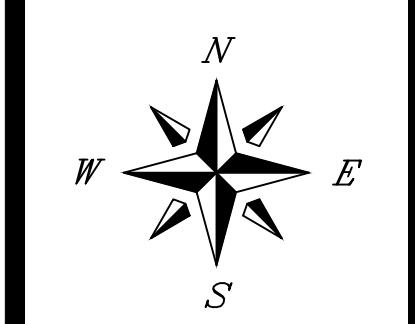

SCALE
 1" = 20'
 ISSUE DATE
 02/14/2024
 PROJECT MANAGER
 JEC
 DESIGNER
 LRT
 QUALITY CONTROL
 MAM

MTFPD STATION #2,
 JOHNSBURG
 PAVEMENT
 REHABILITATION
 JOHNSBURG,
 ILLINOIS

NO.	DATE	DESCRIPTION

PROJECT NUMBER
 MTFP-23087-3

SHEET TITLE
 OVERALL
 SITE PLAN

SHEET NUMBER
 C2.0

- OVERALL NOTES**
1. ALL SIGNING AND PAVEMENT MARKINGS SHALL MEET MUTCD STANDARDS.
 2. PAVEMENT MARKINGS TO BE 4" WIDE PAINT UNLESS OTHERWISE NOTED.
 3. ALL ACCESSIBLE PARKING SIGNS (R7-8) SHALL BE PLACED AT THE CENTER OR THE PARKING SPACE AND WITHIN 5' OF THE SPACE.
 4. ALL DIMENSIONS ARE TO BACK OF CURB, EDGE OF PAVEMENT, AND OUTSIDE OF BUILDING FOUNDATION UNLESS OTHERWISE NOTED.
 5. STRIPING DIMENSIONS ARE FROM CENTER TO CENTER OF PAVEMENT MARKING.
 6. ALL ONSITE CURB SHOWN IS BARRIER CURB UNLESS OTHERWISE NOTED.

LEGEND

- = EXISTING BITUMINOUS PAVEMENT
- = EXISTING CONCRETE SIDEWALK
- = EXISTING BUILDING
- = PROPOSED HEAVY DUTY BITUMINOUS PAVEMENT (PHASE I)
- = PROPOSED HEAVY DUTY CONCRETE PAVEMENT (PHASE I)
- = PROPOSED HEAVY DUTY BITUMINOUS PAVEMENT (PHASE II)
- = PROPOSED HEAVY DUTY CONCRETE PAVEMENT (PHASE II)
- = PROPOSED CONCRETE SIDEWALK (PHASE II)
- = DEPRESSED CURB
- = BARRIER CURB

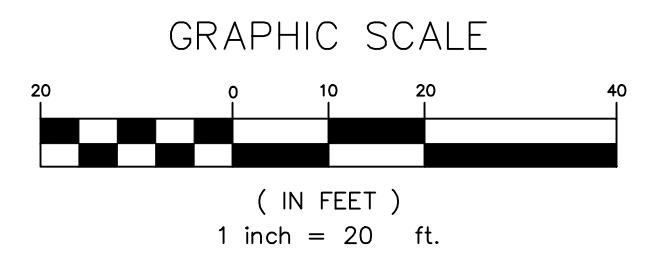
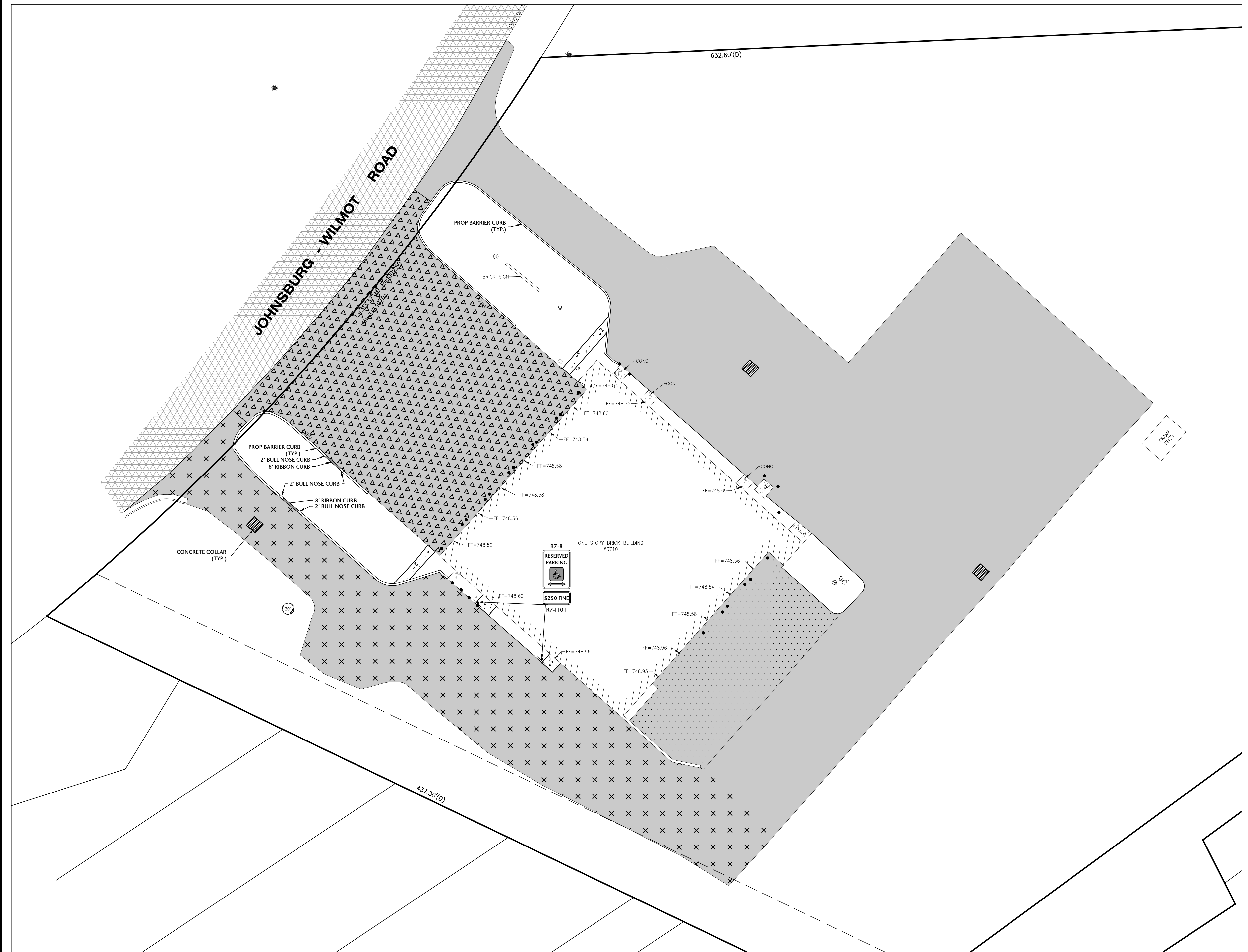

X:\2023\23087\cadd\23087-3.dwg, 2/14/2024, 11:43:56 PM, DWG To PDF.pcs, 1:1

ALTERNATE BID OVERALL SITE PLAN

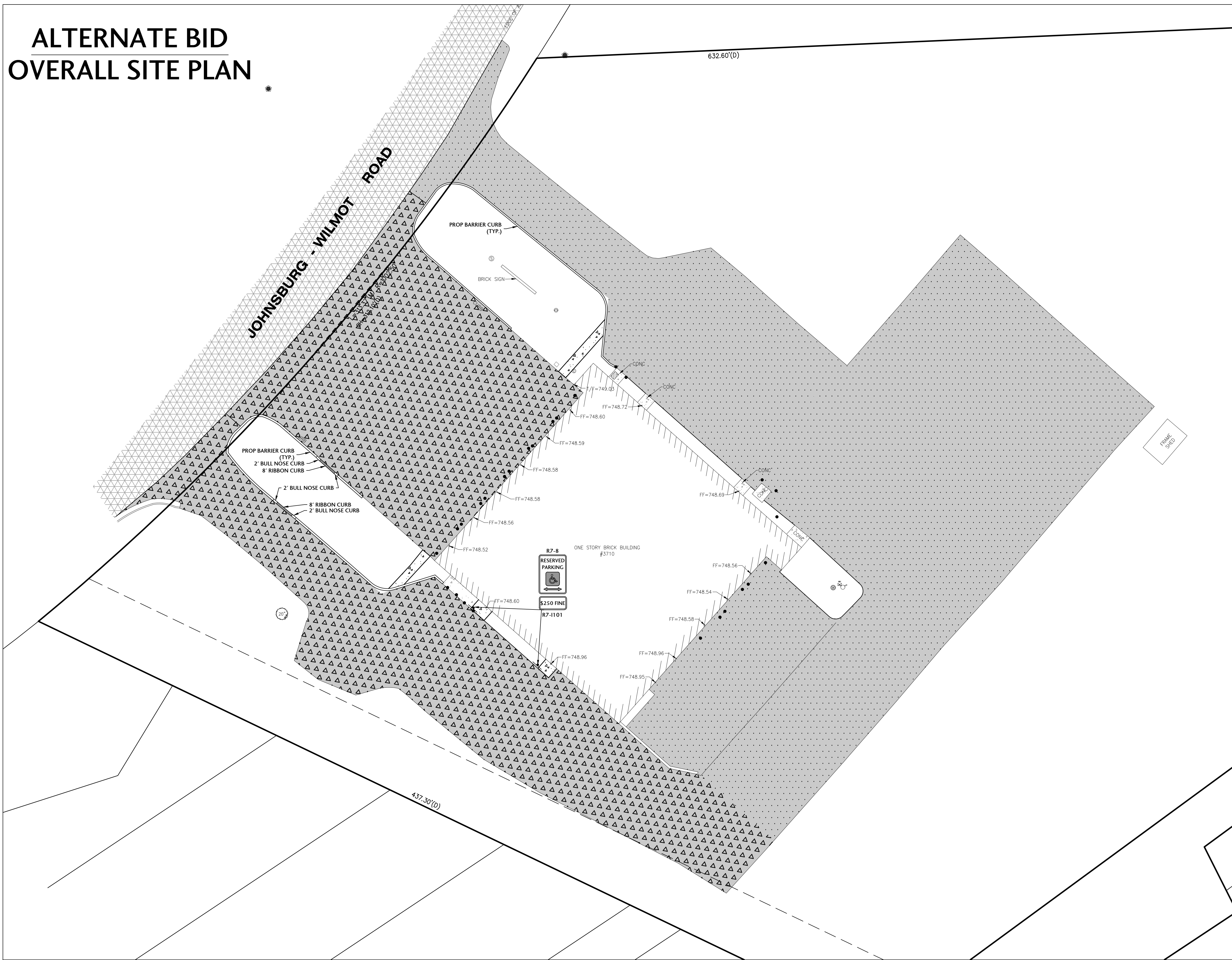

- OVERALL NOTES**
1. ALL SIGNING AND PAVEMENT MARKINGS SHALL MEET MUTCD STANDARDS.
 2. PAVEMENT MARKINGS TO BE 4" WIDE PAINT UNLESS OTHERWISE NOTED.
 3. ALL ACCESSIBLE PARKING SIGNS (R7-8) SHALL BE PLACED AT THE CENTER OR THE PARKING SPACE AND WITHIN 5' OF THE SPACE.
 4. ALL DIMENSIONS ARE TO BACK OF CURB, EDGE OF PAVEMENT, AND OUTSIDE OF BUILDING FOUNDATION UNLESS OTHERWISE NOTED.
 5. STRIPING DIMENSIONS ARE FROM CENTER TO CENTER OF PAVEMENT MARKING.
 6. ALL ONSITE CURB SHOWN IS BARRIER CURB UNLESS OTHERWISE NOTED.

LEGEND

- [Pattern] = EXISTING BITUMINOUS PAVEMENT
- [Pattern] = EXISTING CONCRETE SIDEWALK
- [Pattern] = EXISTING BUILDING
- [Pattern] = PROPOSED HEAVY DUTY CONCRETE PAVEMENT (PHASE I)
- [Pattern] = PROPOSED HEAVY DUTY CONCRETE PAVEMENT (PHASE II)
- [Pattern] = PROPOSED CONCRETE SIDEWALK (PHASE II)
- [Symbol] = DEPRESSED CURB
- [Symbol] = BARRIER CURB

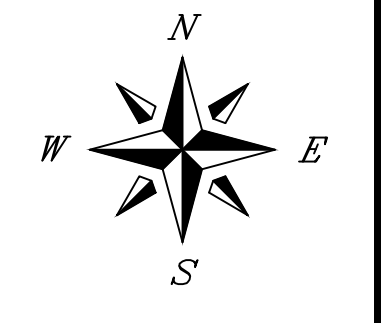
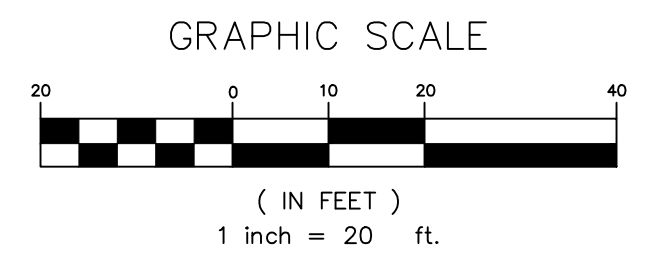

SCALE
1" = 20'

ISSUE DATE
02/14/2024

PROJECT MANAGER
JEC

DESIGNER
LRT

QUALITY CONTROL
MAM

MTFPD STATION #2,
JOHNSBURG
PAVEMENT
REHABILITATION
JOHNSBURG,
ILLINOIS

NO.	DATE	DESCRIPTION

PROJECT NUMBER
MTFP-23087-3

SHEET TITLE
ALTERNATE BID
OVERALL
SITE PLAN

SHEET NUMBER
C2.1

X:\2023\23087\cand\23087-3.dwg, 2/14/2024 11:14:59 PM, DWG To PDF, pgs. 1 of 1



J. CONDON & ASSOCIATES, INC.
CONSULTING ENGINEERS
5415 BUSINESS PARKWAY
RINGWOOD, ILLINOIS 60072
815.728.0068
IL DESIGN FIRM # 184-006759

McHENRY TWP.
FIRE PROTECTION
DISTRICT
McHENRY,
ILLINOIS

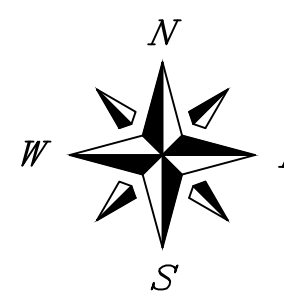

SCALE
1" = 20'
ISSUE DATE
02/14/2024
PROJECT MANAGER
JEC
DESIGNER
LRT
QUALITY CONTROL
MAM

MTFPD STATION #2,
JOHNSBURG
PAVEMENT
REHABILITATION
JOHNSBURG,
ILLINOIS

GRADING & EROSION CONTROL NOTES:

1. ALL DISTURBED AREAS SHALL BE STABILIZED WITH NA GREEN DS75 EROSION BLANKET OR APPROVED EQUAL OR HYDROSEEDED UNLESS OTHERWISE NOTED WITHIN THE PLAN SET.
2. CONTRACTOR RESPONSIBLE FOR MAINTENANCE/REPAIR OF EROSION CONTROL MEASURES UNTIL ADEQUATE VEGETATION GROWTH HAS OCCURRED. MAINTENANCE/REPAIR WORK SHALL BE INCIDENTAL TO THE INSTALLATION COSTS.
3. CONTRACTOR RESPONSIBLE FOR ADDITIONAL EROSION CONTROL MEASURES AS RECOMMENDED BY THE ENFORCEMENT OFFICER OR THE DESIGNATED EROSION INSPECTOR AS SITE CONDITIONS WARRANT.
4. ALL TRAPPED SEDIMENT IS TO BE PROPERLY STABILIZED OR DISPOSED OF.
5. IF CONTRACTOR NEEDS TO DEWATER WHEN EXCAVATING, THEY MUST PUMP TO A "DIRT BAG" OR APPROVED EQUAL.
6. WHERE THE USE OF TREE PROTECTION FENCING DOES NOT PROVIDE AMPLE ROOM FOR CONSTRUCTION, TREE TRUNK PROTECTION SHALL BE USED.
7. TEMPORARY SEEDING SHALL BE REQUIRED TO TEMPORARILY STABILIZE DISTURBED AREAS THAT WILL NOT BE BROUGHT TO FINAL GRADE OR ON WHICH CONSTRUCTION WILL BE STOPPED FOR A PERIOD OF MORE THAN 14 DAYS. THE COVER CROP SEED MIX SHALL BE UTILIZED FOR TEMPORARY SEEDING.
8. CONTRACTOR IS RESPONSIBLE TO EMPLOY DUST CONTROL METHODS TO REDUCE & PREVENT THE SURFACE AND AIR TRANSPORT OF DUST DURING CONSTRUCTION. IN ADDITION TO MINIMIZATION OF SOIL DISTURBANCE, CONTRACTOR SHALL UTILIZE MULCHING METHODS (DOT 251.03 OR 251.04), IRRIGATION AND BARRIERS.

PROP ST SEWER NOTES

1. PROP 12" FES
INV = 742.00
2. PROP 40 LF 12" ST SEWER @ 0.25%
3. PROP CB TA 4" DIA T1F OL
RIM = 745.50
INV = 742.10
4. PROP 125 LF 12" ST SEWER @ 2.00%
5. PROP INLET TA 2" DIA T1F OL
RIM = 747.10
INV = 744.60
6. PROP 60 LF 6" ST DRAIN
W/ DOWNSPOUT CONNECTION
(SEE DETAIL)
7. PROP 15 LF 6" ST DRAIN
W/ DOWNSPOUT CONNECTION
(SEE DETAIL)
8. PROP 65 LF 6" ST DRAIN
W/ DOWNSPOUT CONNECTION
(SEE DETAIL)
9. PROP 25 LF 6" ST DRAIN
W/ DOWNSPOUT CONNECTION
(SEE DETAIL)
10. PROP 15" FES
INV = 743.80
11. PROP 25 LF 15" ST SEWER @ 0.20%
12. PROP CB TA 4" DIA T1F OL
RIM = 747.10
INV = 743.85
13. PROP 25 LF 12" ST SEWER @ 0.20%
14. PROP INLET TA 2" DIA T8F
RIM = 746.75
INV = 743.90
15. PROP 30 LF 12" ST SEWER @ 0.33%
16. PROP INLET TA 2" DIA T1F OL
RIM = 747.25
INV = 744.00
17. PROP 75 LF 4" UNDERDRAIN
(SEE DETAIL)
18. PROP 95 LF 4" UNDERDRAIN
(SEE DETAIL)
19. PROP 55 LF 6" ST DRAIN
W/ DOWNSPOUT CONNECTION
(SEE DETAIL)
20. PROP 55 LF 6" ST DRAIN
W/ DOWNSPOUT CONNECTION
(SEE DETAIL)
21. PROP 50 LF 6" ST DRAIN
W/ DOWNSPOUT CONNECTION
(SEE DETAIL)
DAYLIGHT ELEV = 743.0

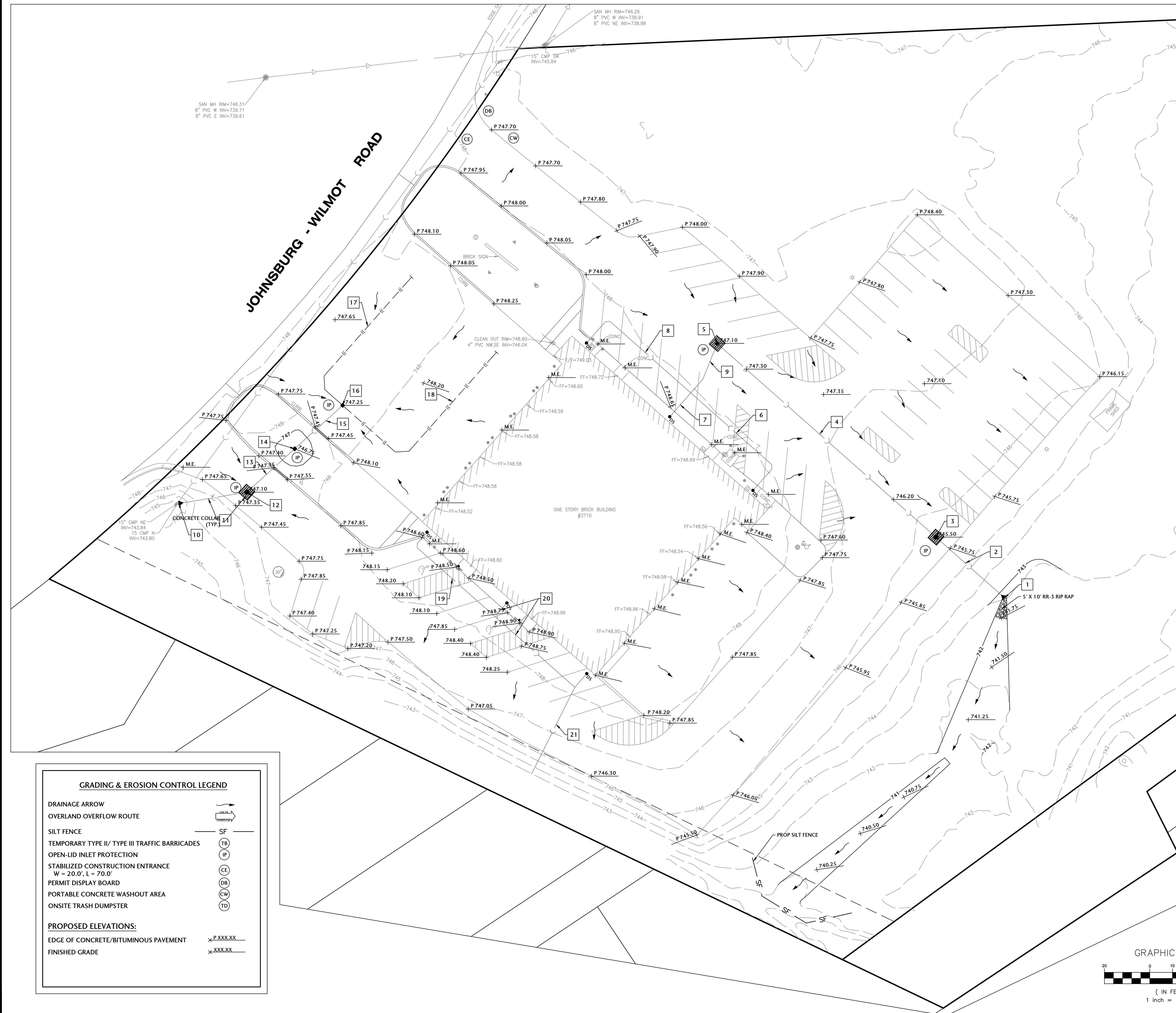

GRADING & EROSION CONTROL LEGEND

DRAINAGE ARROW

OVERLAND OVERFLOW ROUTE

SILT FENCE

TEMPORARY TYPE II / TYPE III TRAFFIC BARRICADES

OPEN-LID INLET PROTECTION

STABILIZED CONSTRUCTION ENTRANCE
W = 20.0', L = 70.0'

PERMIT DISPLAY BOARD

PORTABLE CONCRETE WASHOUT AREA

ONSITE TRASH DUMPSTER

PROPOSED ELEVATIONS:

EDGE OF CONCRETE/BITUMINOUS PAVEMENT

FINISHED GRADE

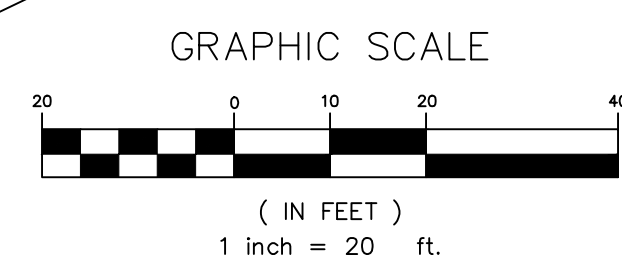

NO.	DATE	DESCRIPTION

PROJECT NUMBER
MTFP-23087-3

SHEET TITLE
UTILITY & GRADING PLAN

SHEET NUMBER
C3.0

X:\2023\23087\23087-3.dwg, 2/14/2024, 10:27 PM, DLG To PDF, ps, 1:1

STABILIZED CONSTRUCTION ENTRANCE PLAN

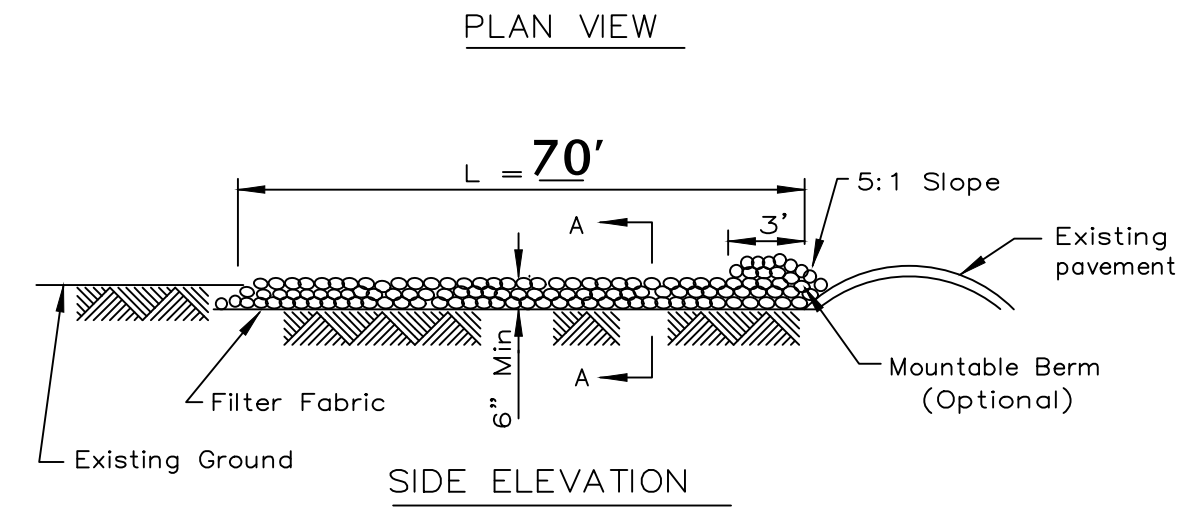
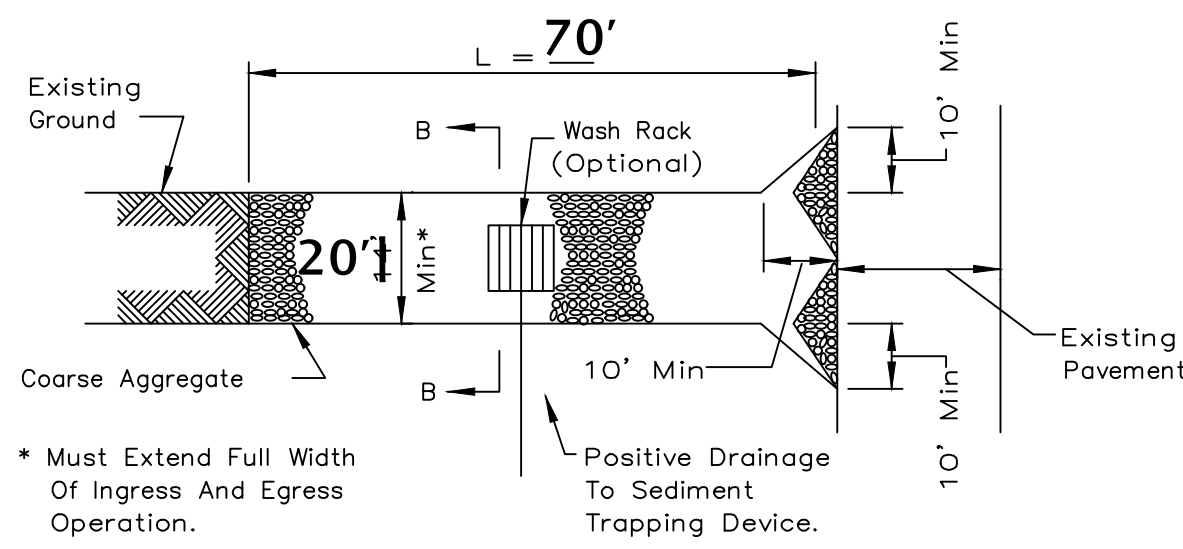

NOTES: 1. Filter fabric shall meet the requirements of material specification 592 GEOTEXTILE, Table 1 or 2, Class 1 or 1a... 2. Rock or reclaimed concrete shall meet one of the following IDOT coarse aggregate gradation, CA-1, CA-2, CA-3 or CA-4...

REFERENCE Project, Design, Checked, Approved table with dates and NRCS logo.

STABILIZED CONSTRUCTION ENTRANCE PLAN

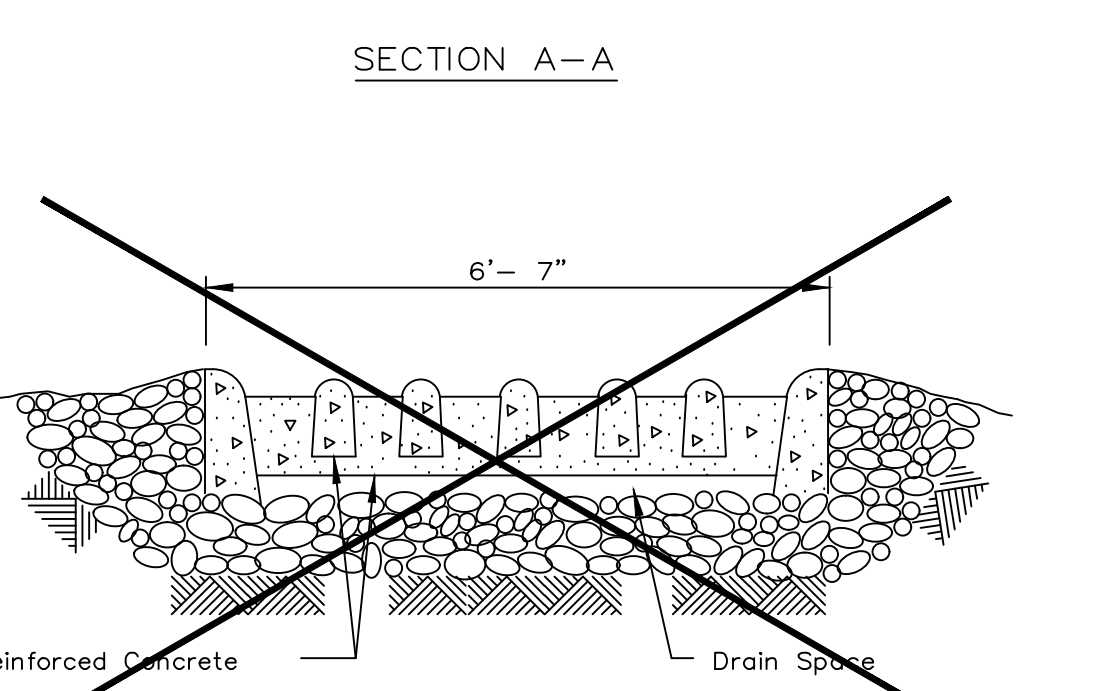
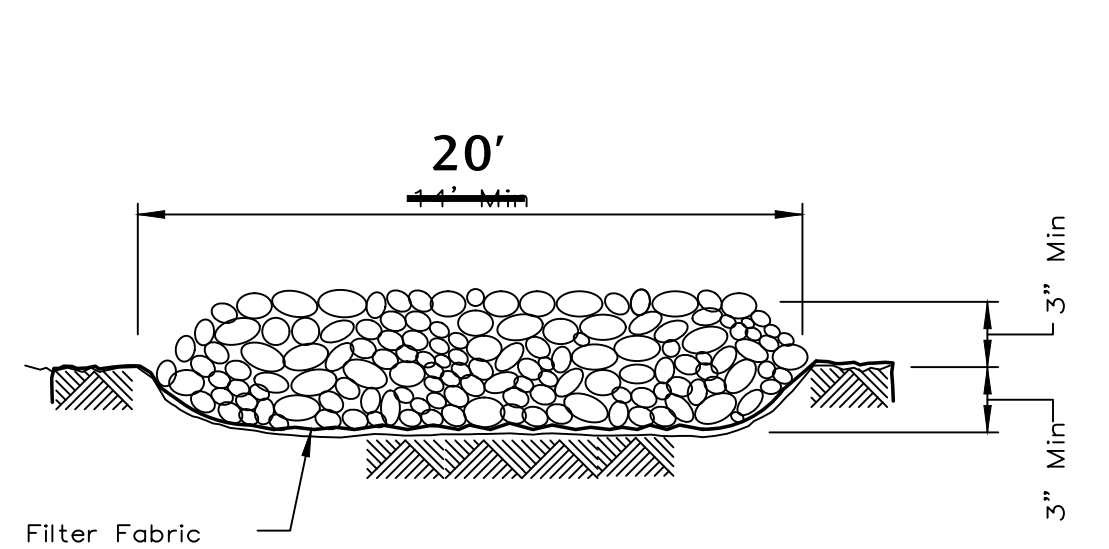

CONSTRUCTION ENTRANCE - IF NEEDED, EXISTING PAVEMENT IS ANTICIPATED TO BE THE TEMPORARY CONSTRUCTION ENTRANCE DURING CONSTRUCTION

REFERENCE Project, Design, Checked, Approved table with dates and NRCS logo.

EROSION BLANKET PLAN

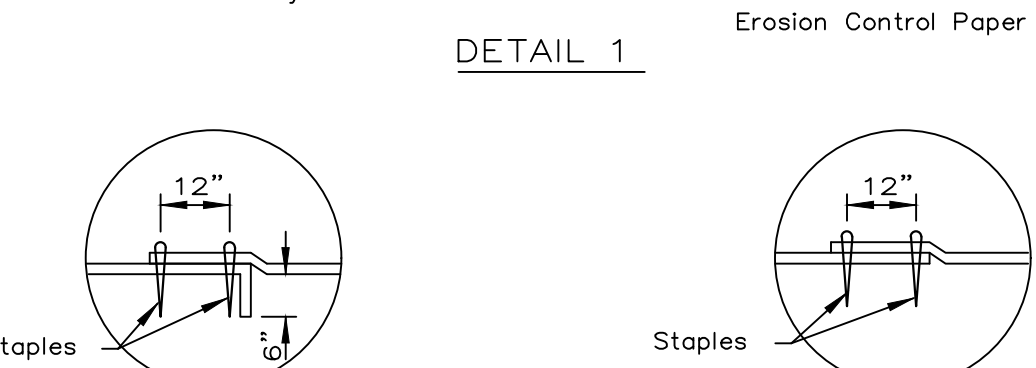
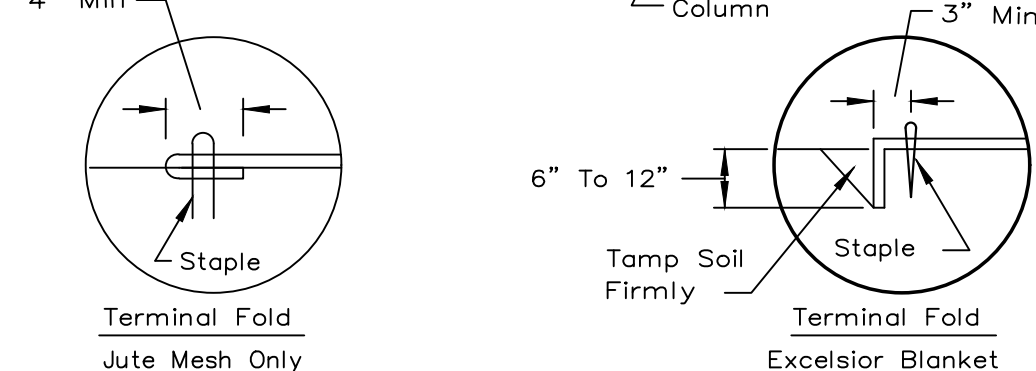
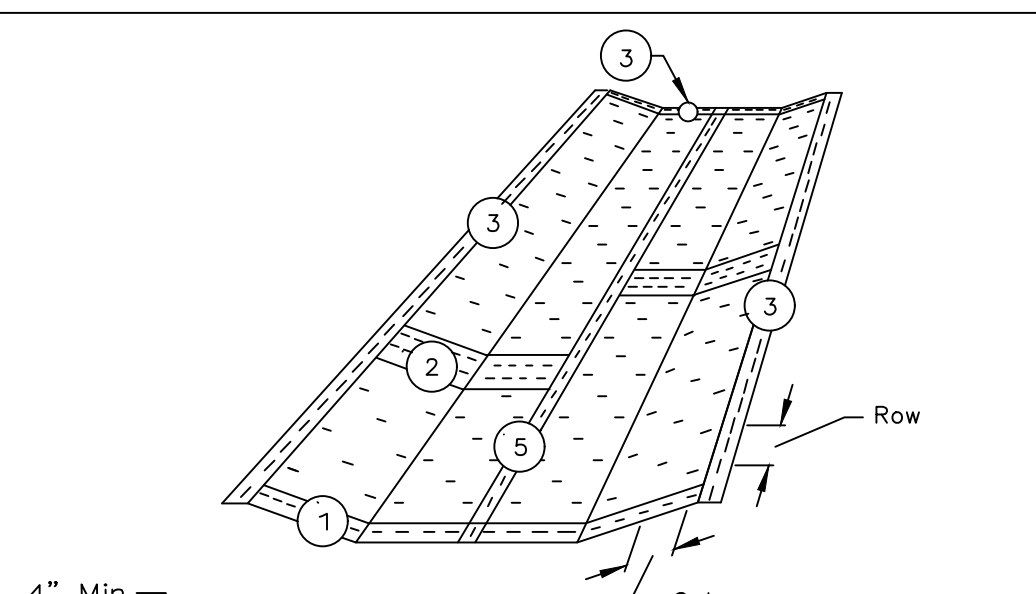

REFERENCE Project, Design, Checked, Approved table with dates and NRCS logo.

EROSION BLANKET PLAN

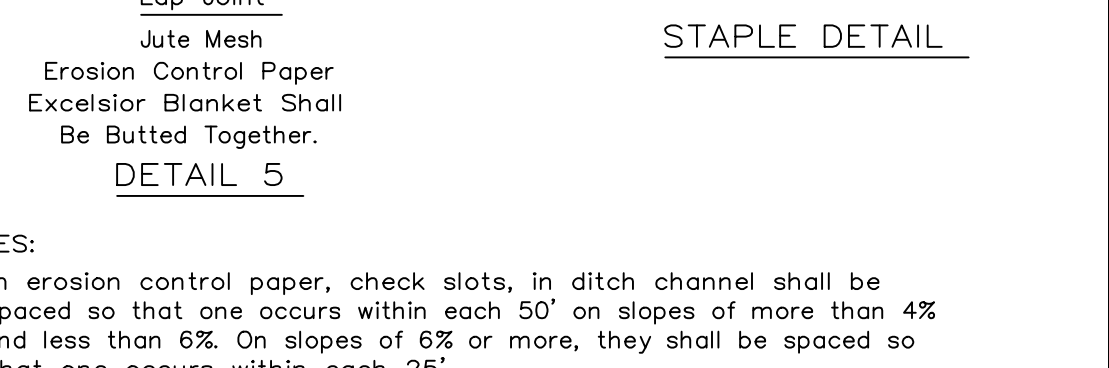
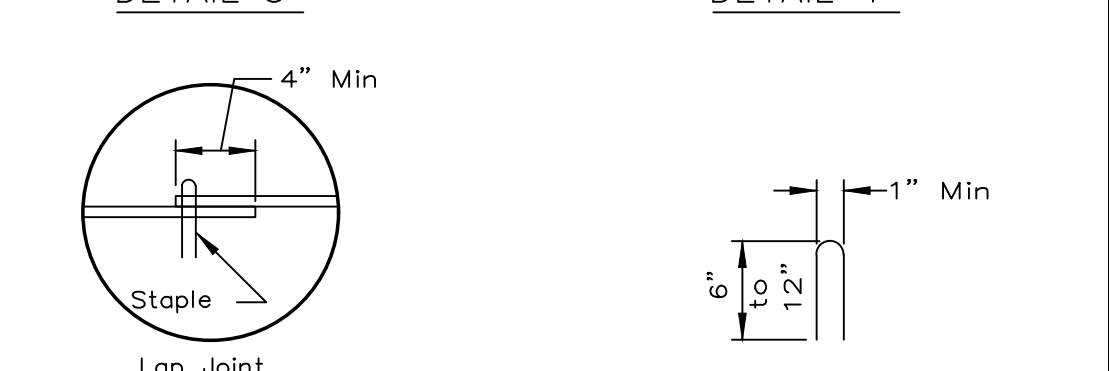
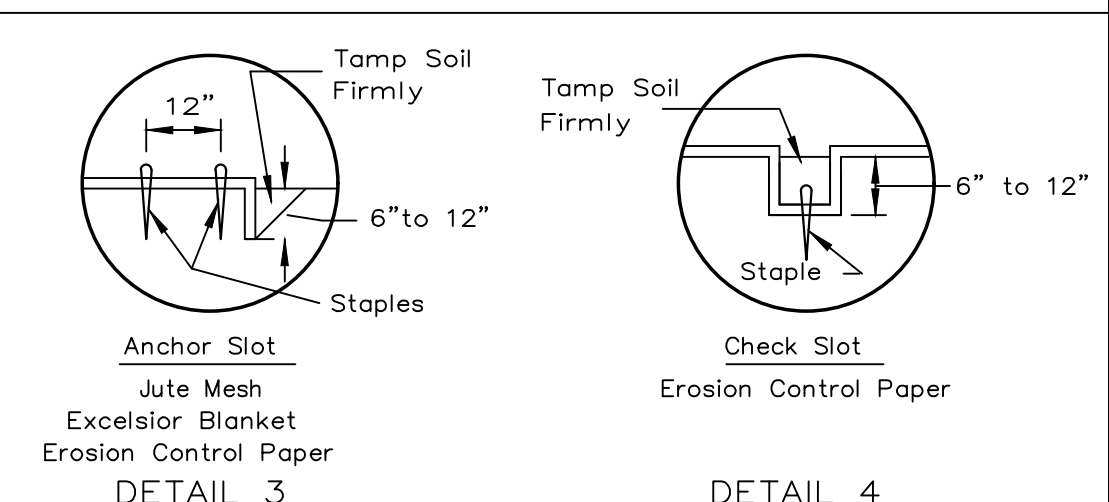

REFERENCE Project, Design, Checked, Approved table with dates and NRCS logo.

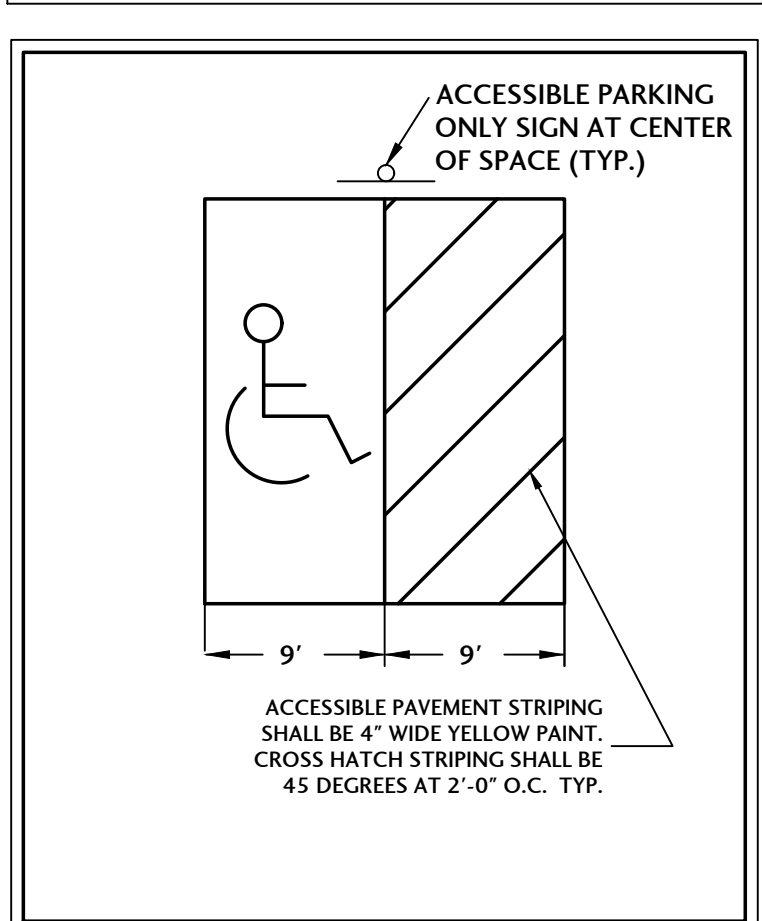
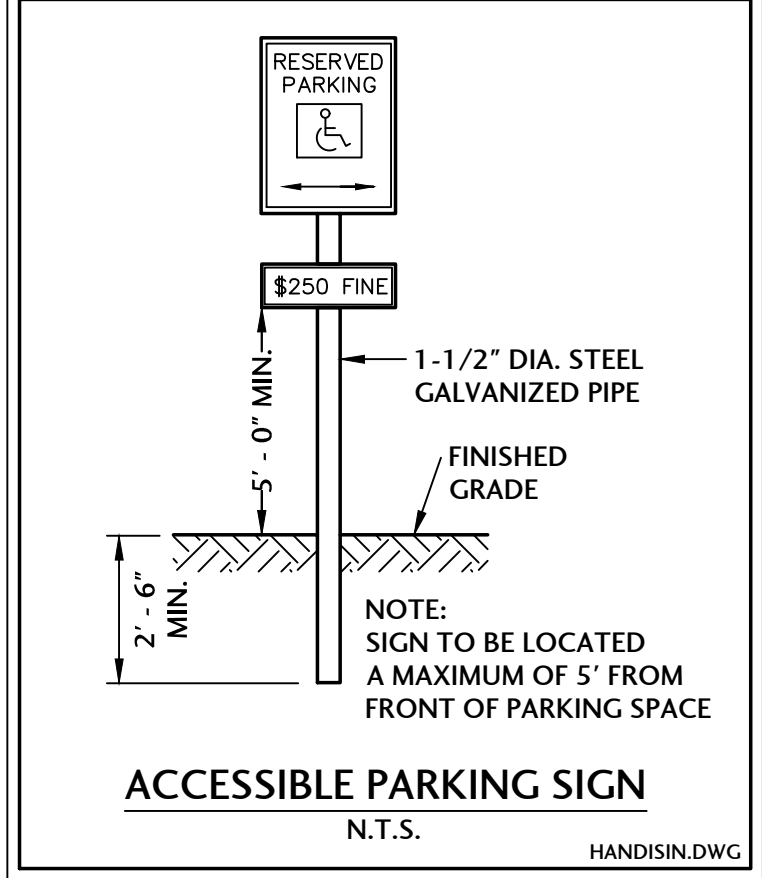

McHENRY TWP. FIRE PROTECTION DISTRICT McHENRY, ILLINOIS. Includes logo, address, and project details.

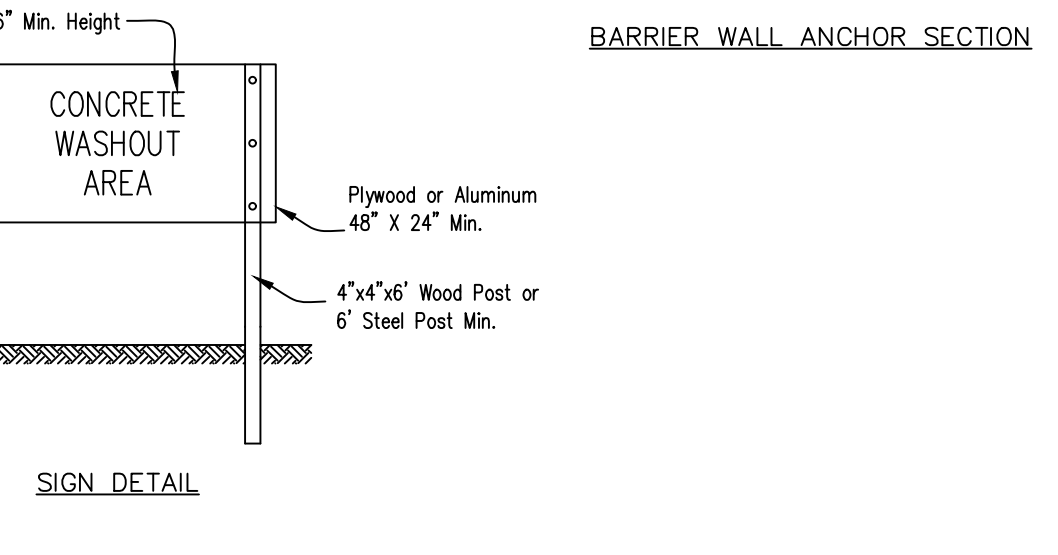
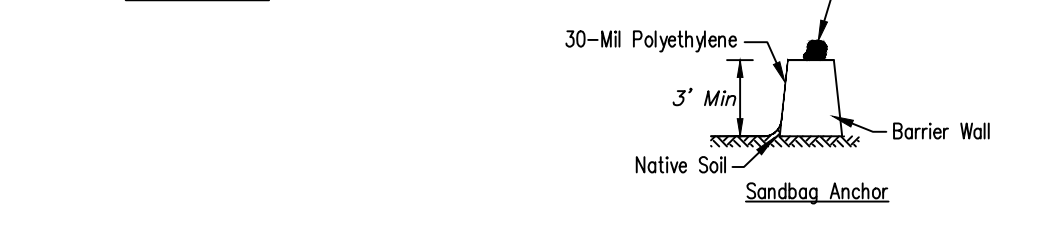
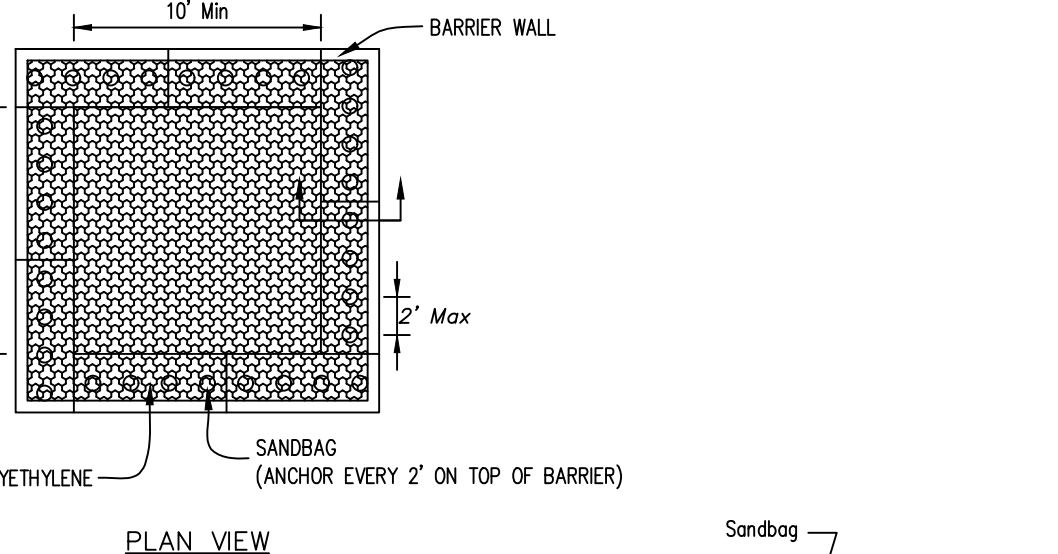

NOTES: 1. Maintaining temporary concrete washout facilities shall include removing and disposing of hardened concrete and/or slurry... 2. Facility shall be cleaned or reconstructed in a new area once washout becomes two-thirds full.

REFERENCE Project, Design, Checked, Approved table with dates and NRCS logo.

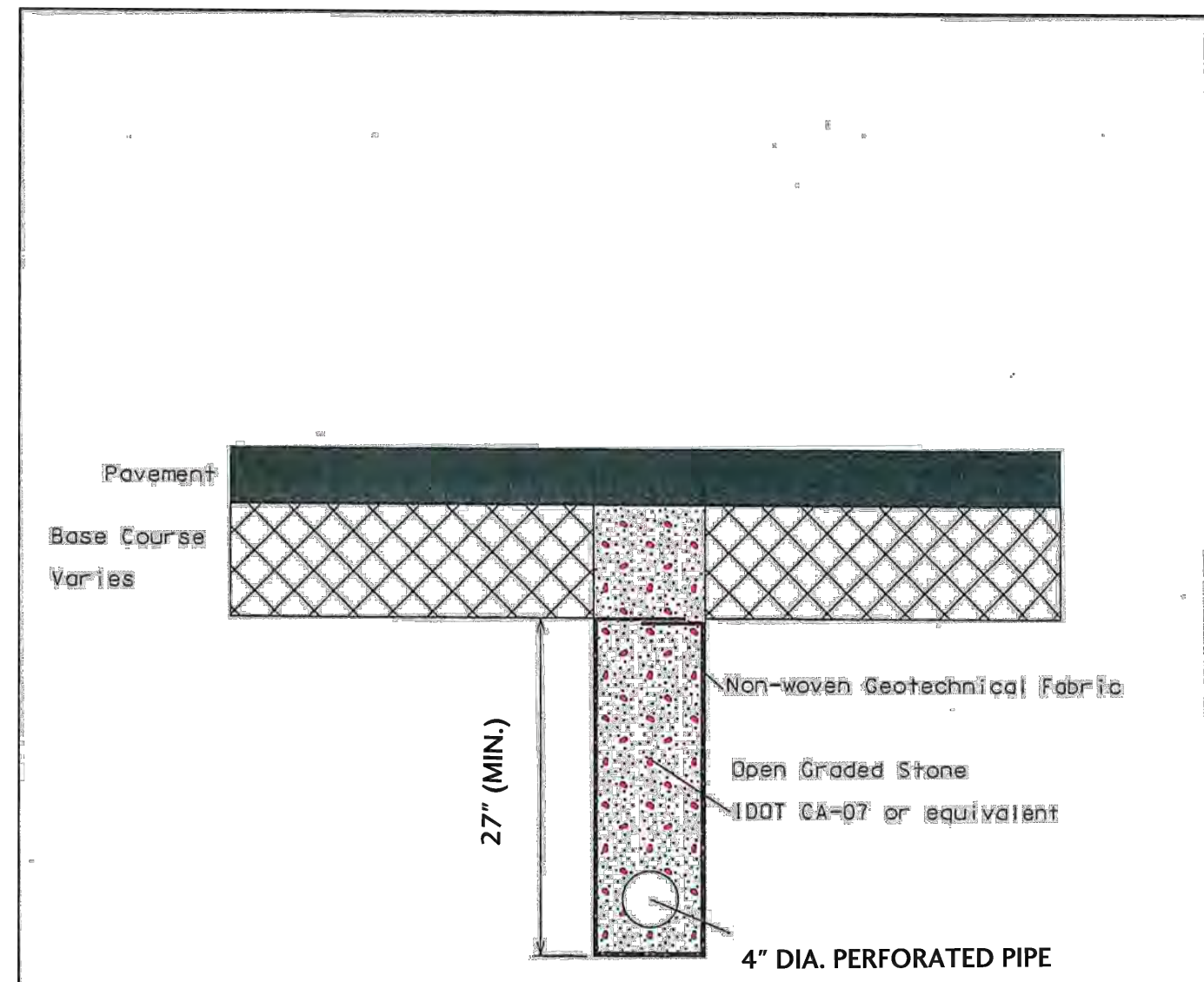

REFERENCE Project, Design, Checked, Approved table with dates and NRCS logo.

INLET PROTECTION LOG TYPE

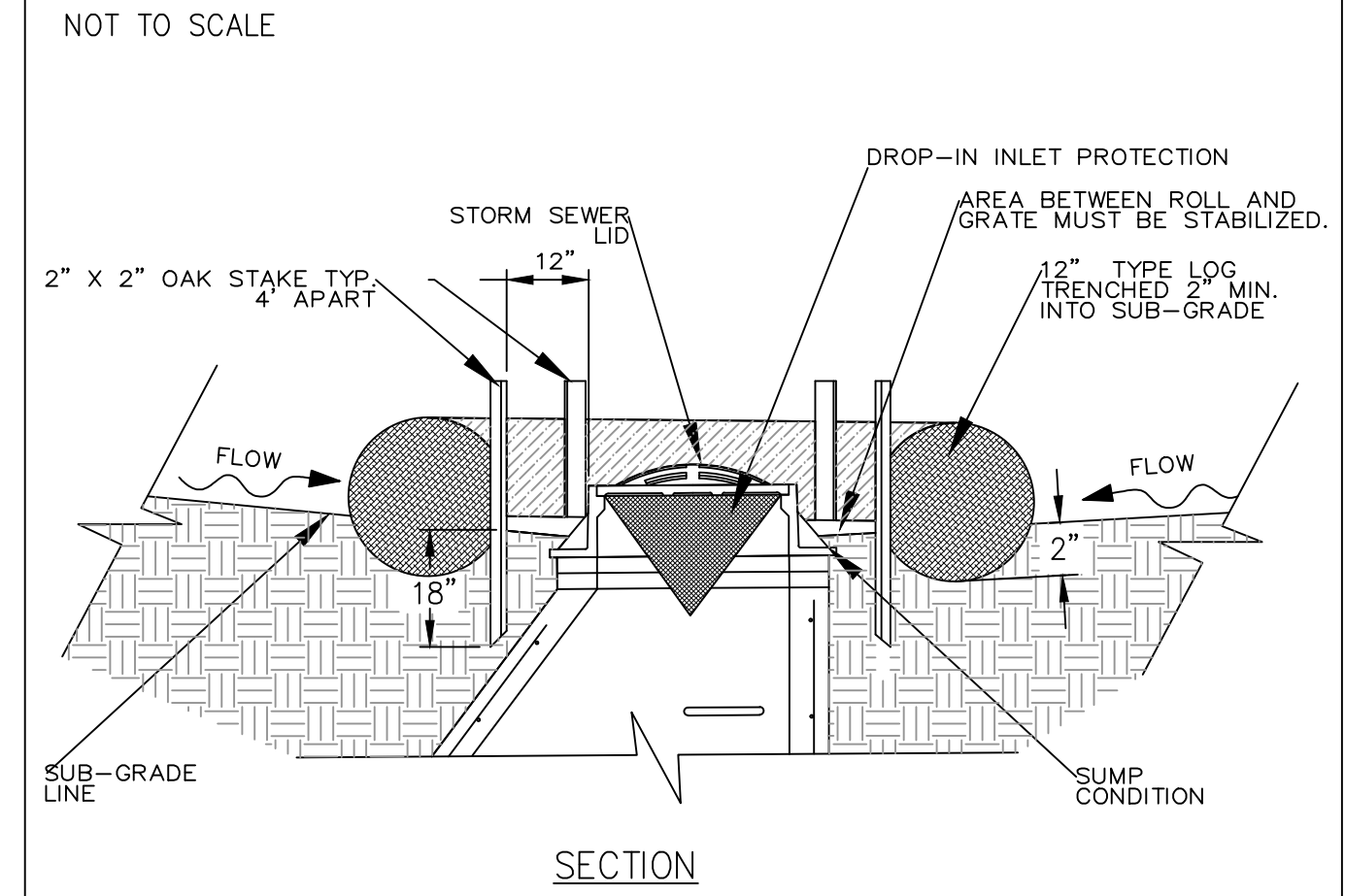

NOTES: 1. 2" x 2" nominal hardwood stakes, 4 foot minimum length, driven into ground approximately 18 inches, stakes driven a minimum width of 12 inches away from the drop inlet... 2. Area inside the log, from edge of fabric to structure, must be stabilized with erosion control blanket...

REFERENCE Project, Design, Checked, Approved table with dates and NRCS logo.

INLET PROTECTION - PAVED AREAS DROP-IN PROTECTION

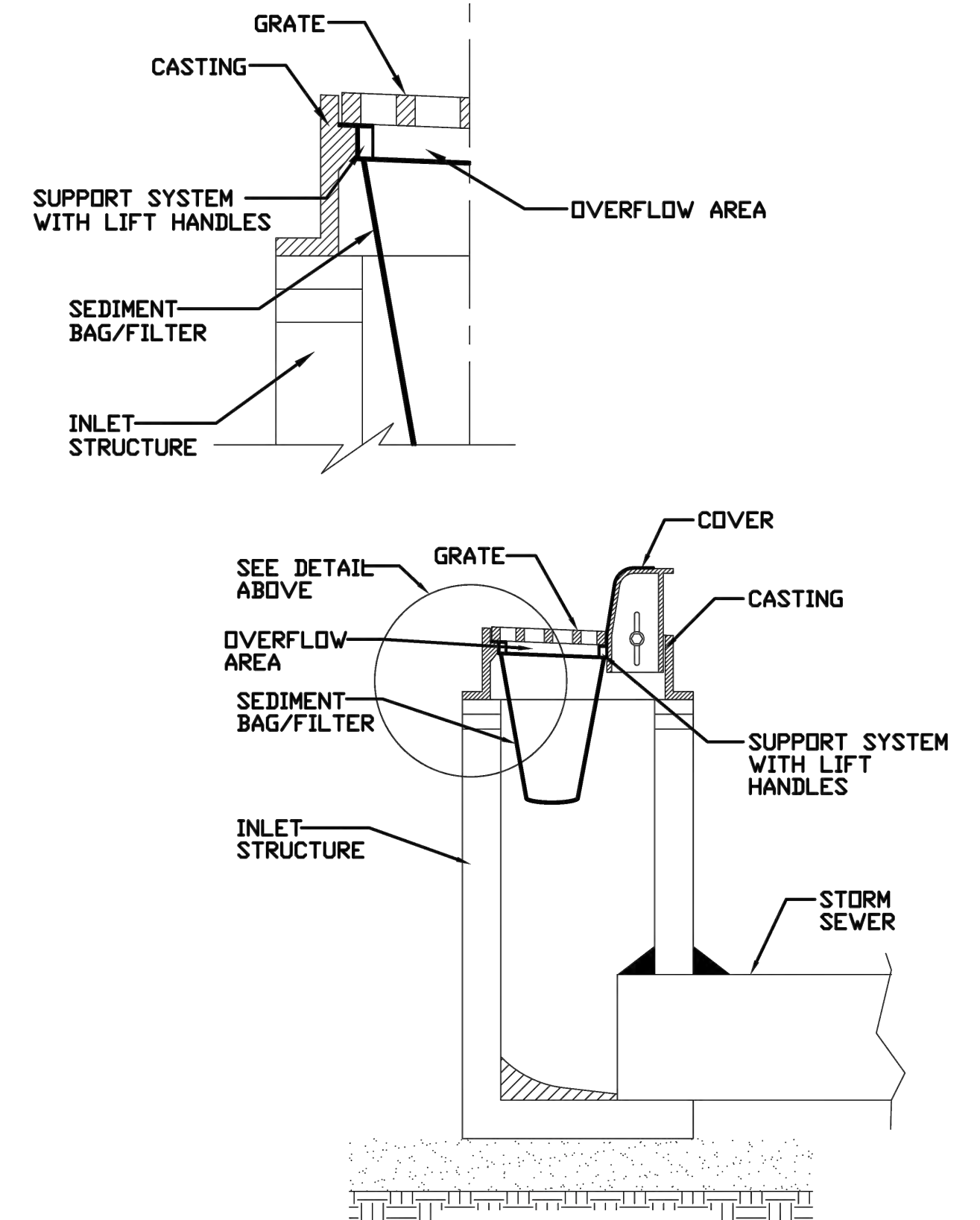

REFERENCE Project, Design, Checked, Approved table with dates and NRCS logo.

Table with columns for Description, Date, No., Project Number (MTFP-23087-3), Sheet Title, Standard Details, and Sheet Number (C4.0).

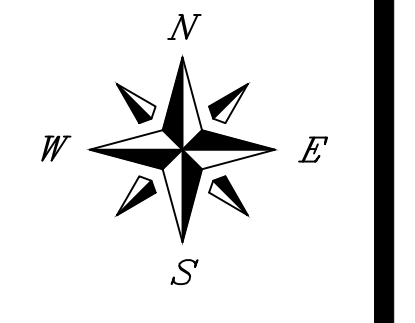
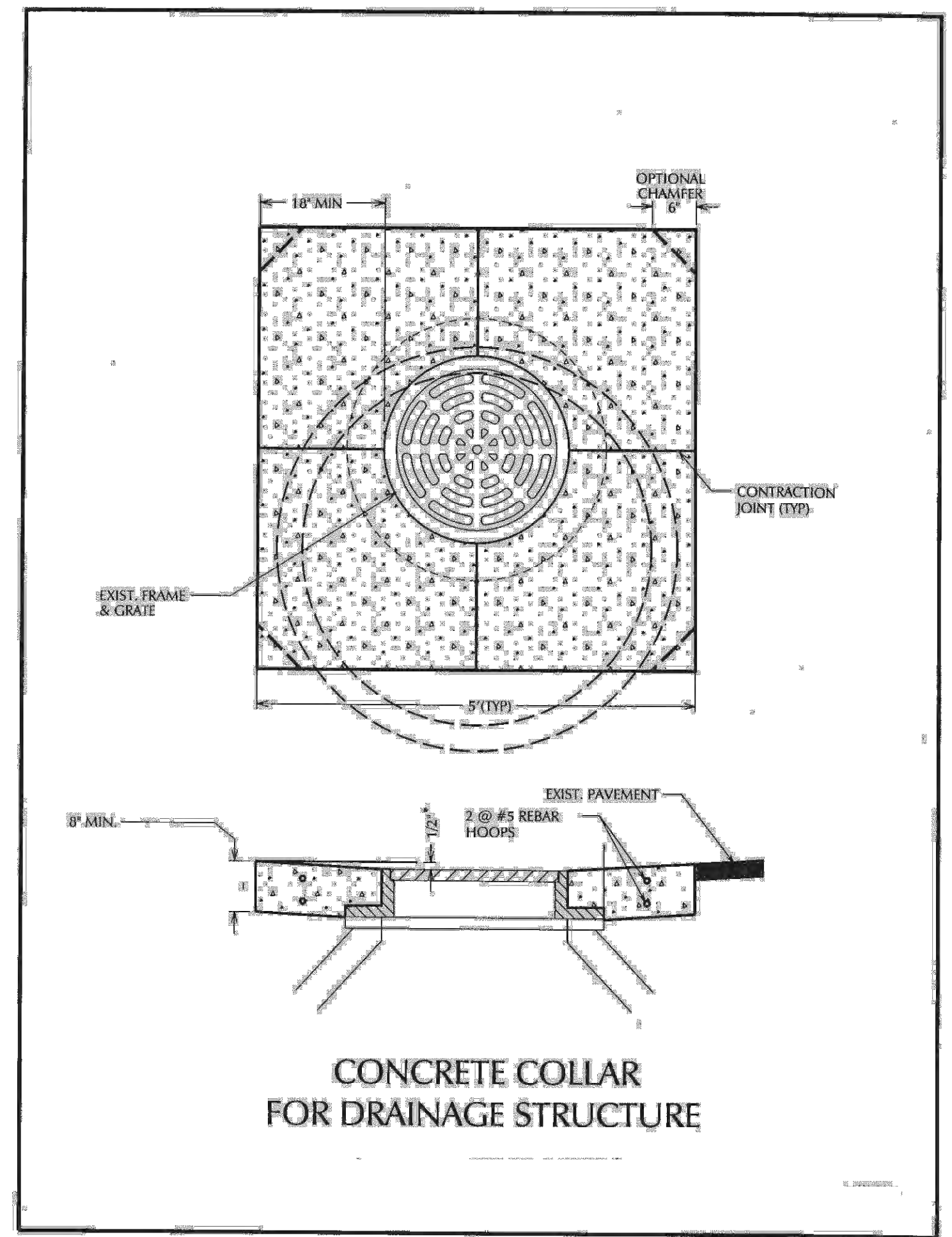
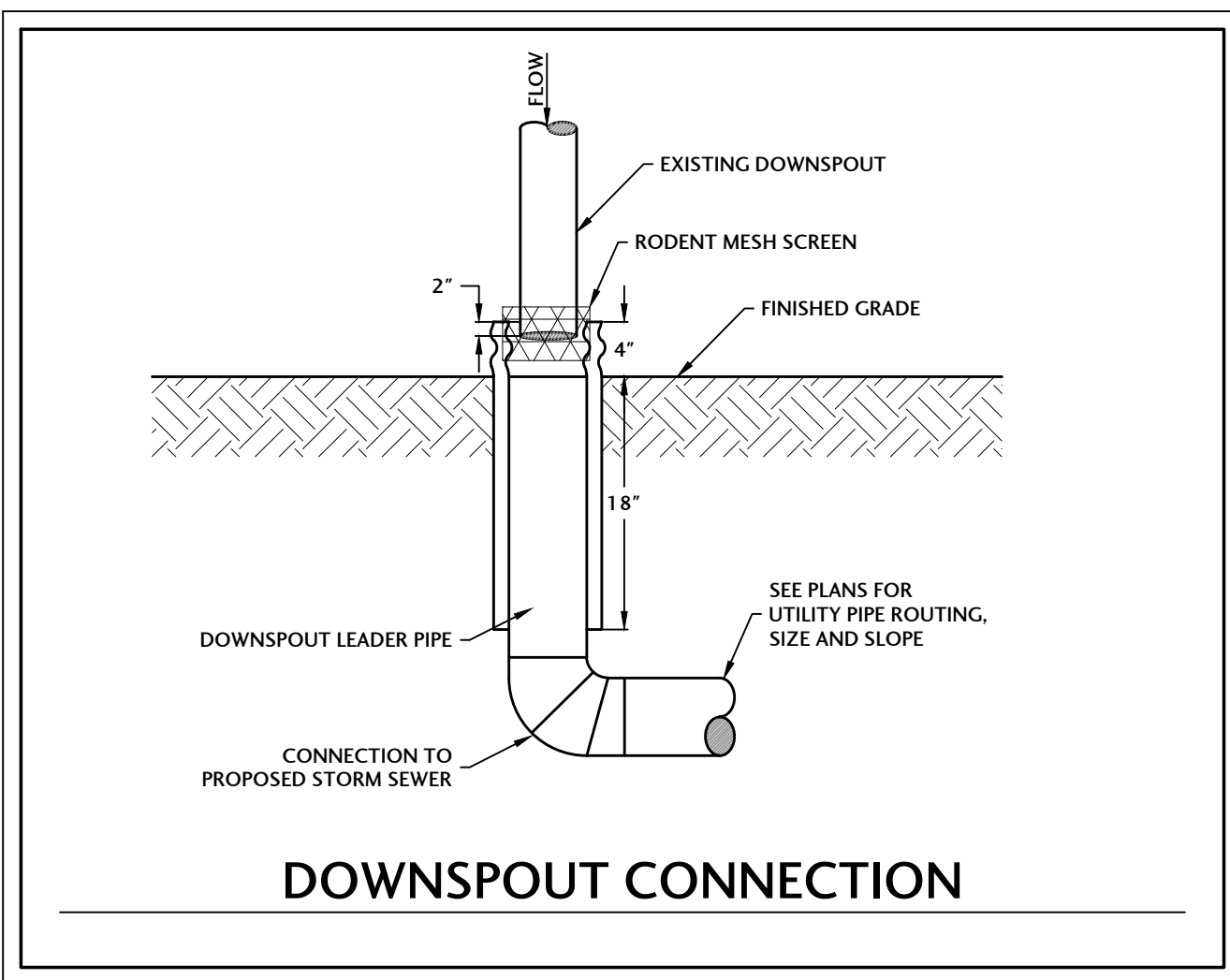
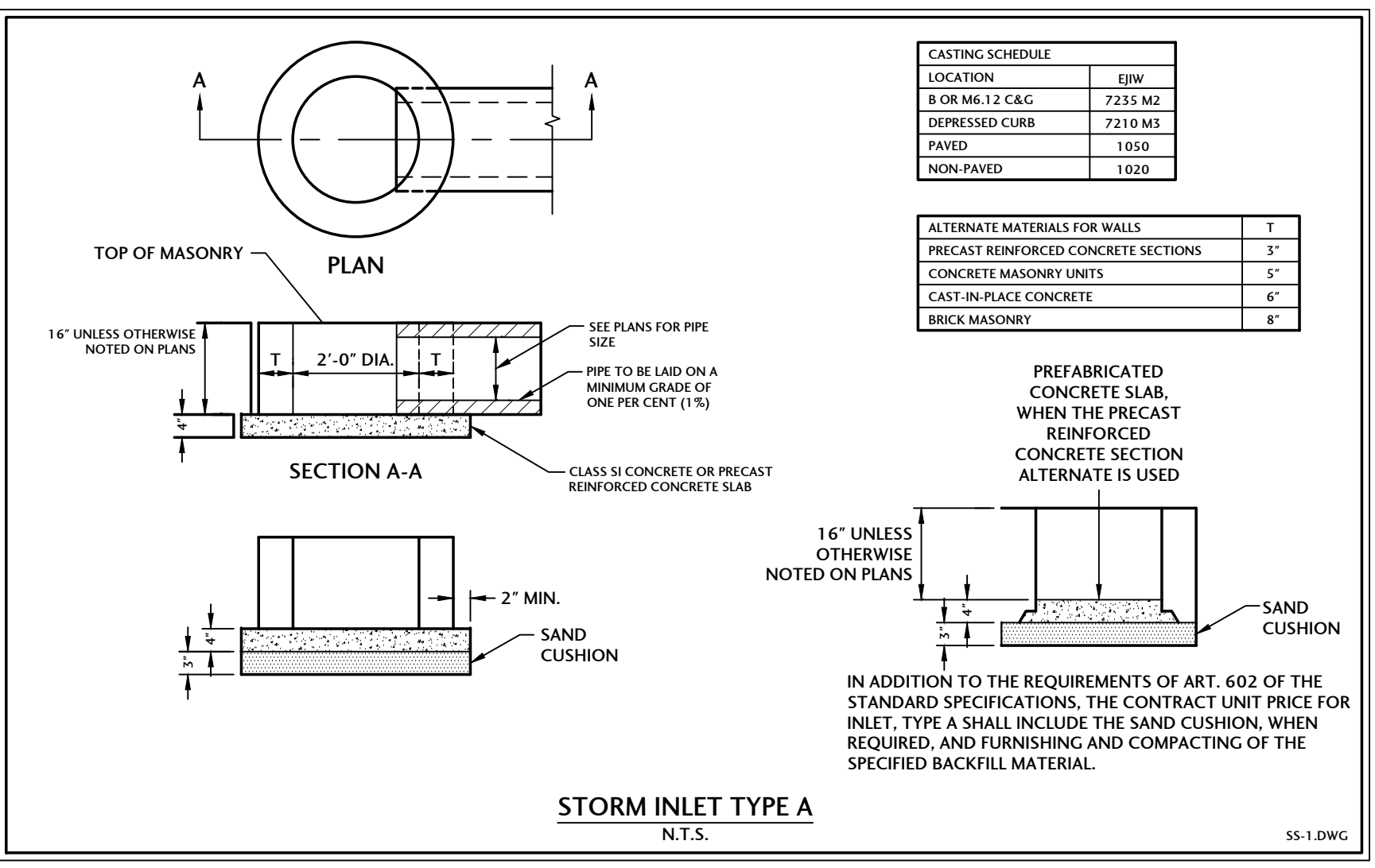
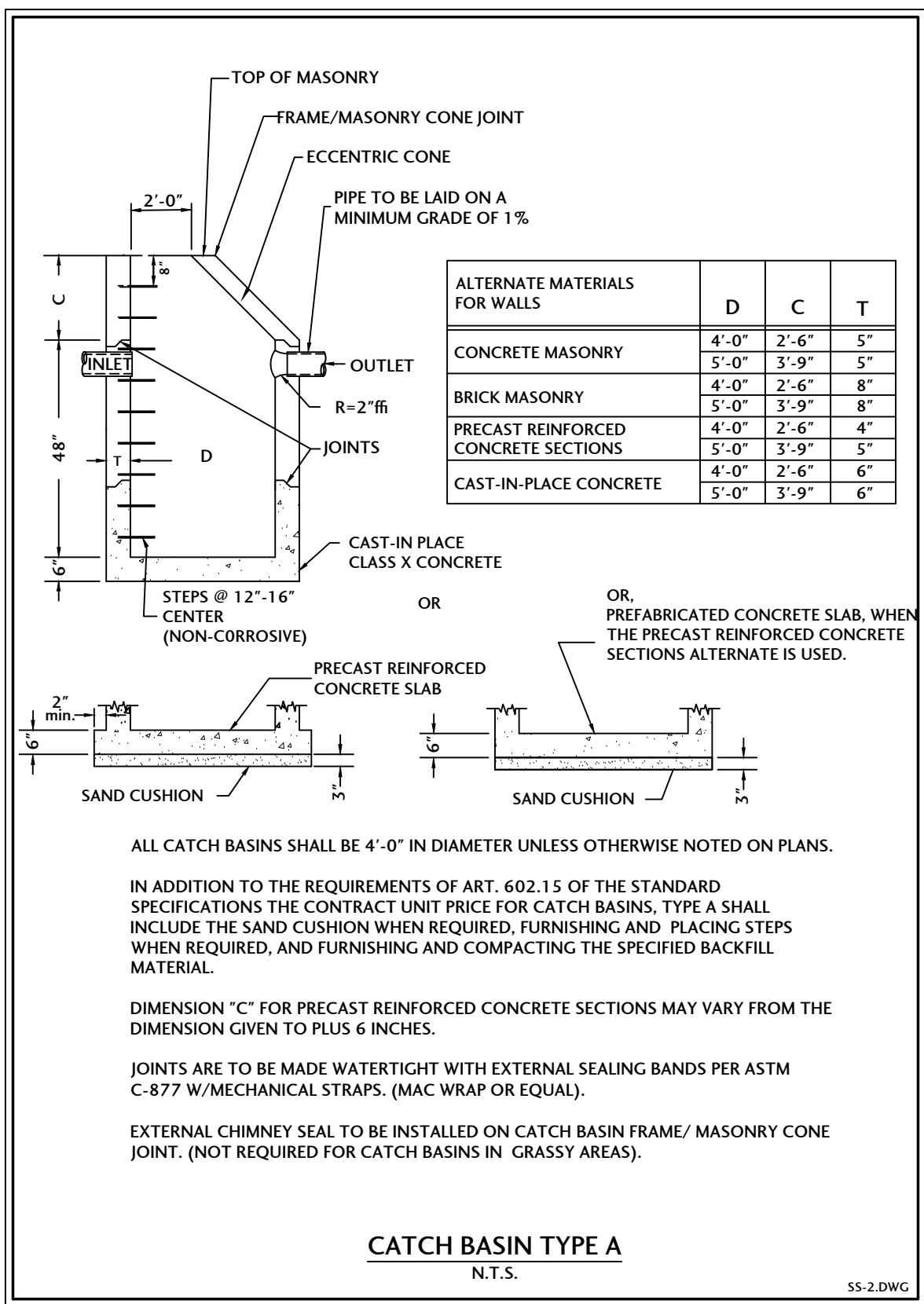

SCALE	N/A
ISSUE DATE	02/14/2024
PROJECT MANAGER	JEC
DESIGNER	LRT
QUALITY CONTROL	MAM

MTFPD STATION #2,
JOHNSBURG
PAVEMENT
REHABILITATION
JOHNSBURG,
ILLINOIS

NO.	DATE	DESCRIPTION

PROJECT NUMBER	MTFP-23087-3
SHEET TITLE	STANDARD DETAILS
SHEET NUMBER	C4.1

PROJECT NUMBER	MTFP-23087-3
SHEET TITLE	STANDARD DETAILS
SHEET NUMBER	C4.1